

City of Grosse Pointe Woods

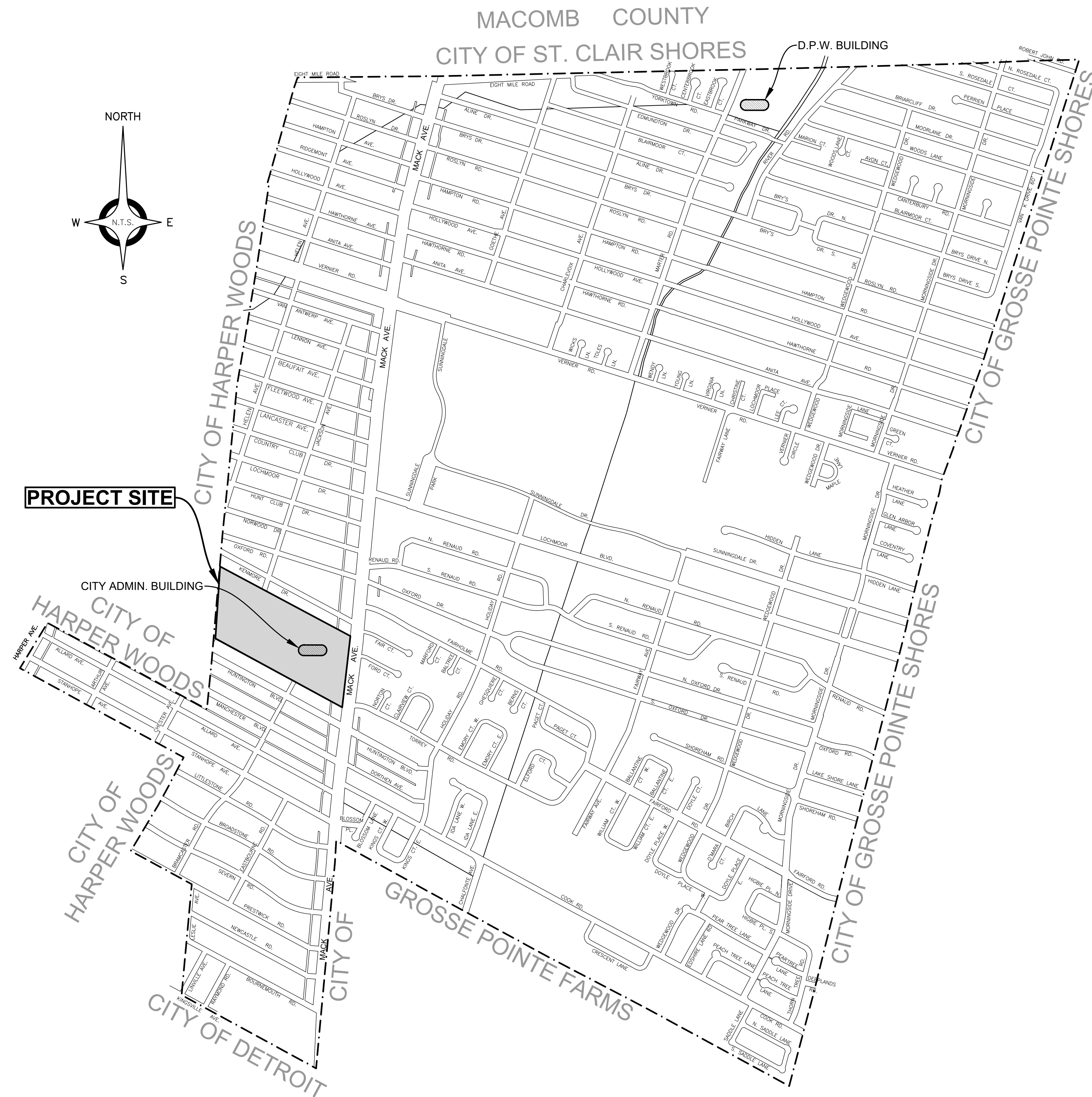

Wayne County, Michigan

Ghesquiere Park Walking Path

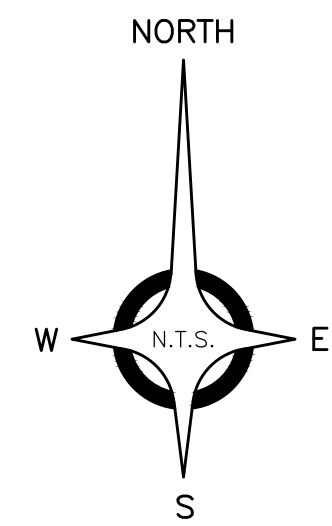

INDEX TO SHEETS

TITLE SHEET	1
NOTE SHEET	2
CONSTRUCTION & GRADING PLAN	3 thru 5
ALTERNATE BID CONSTRUCTION PLAN	6
SOIL EROSION & SEDIMENTATION CONTROL	7 thru 10

CITY OF GROSSE POINTE WOODS STD. DETAILS

PAVING DETAILS	E
----------------------	---

DESIGN & CONSTRUCTION STANDARD

THE IMPROVEMENTS COVERED BY THESE PLANS SHALL BE PERFORMED IN ACCORDANCE WITH THE MICHIGAN DEPARTMENT OF TRANSPORTATION 2020 STANDARD SPECIFICATIONS FOR CONSTRUCTION AND THE CITY OF GROSSE POINTE WOODS STANDARD SPECIFICATIONS UNLESS MODIFIED BY A SPECIAL PROVISION.

ALL TRAFFIC CONTROL DEVICES SUCH AS LIGHTED ARROW BOARDS, PLASTIC DRUMS, BARRICADES, TEMPORARY SIGNAGE, AND LANE CLOSURES SHALL BE IMPLEMENTED IN ACCORDANCE WITH THE 2011 MICHIGAN MANUAL OF UNIFORM TRAFFIC CONTROL DEVICES AND THE SUPPLEMENTARY MAINTAINING TRAFFIC SPECIAL PROVISION.

PROJECT DESCRIPTION

THE PROJECT CONSISTS OF 0.5 MILES OF WALKING PATH CONSTRUCTION. THE CONSTRUCTION WORK INVOLVES GRADING, AGGREGATE BASE AND HMA PLACEMENT ALONG THE PROPOSED PATH ALIGNMENT. THE PROJECT ALSO INCLUDES SIDEWALK RAMP RECONSTRUCTION, AND OTHER MISCELLANEOUS RELATED ITEMS OF WORK.

LOCAL AUTHORITY APPROVAL
CITY OF GROSSE POINTE WOODS

JIM KOWALSKI, DIRECTOR OF PUBLIC SERVICES

DATE

"I HEREBY CERTIFY THESE PLANS HAVE BEEN PREPARED UNDER MY DIRECT SUPERVISION IN ACCORDANCE WITH ACT 240, PUBLIC ACTS OF 1937 AS AMENDED- STATE OF MICHIGAN."

ROSS T. WILBERDING, P.E. No. 6201068836

DATE

GENERAL NOTES

UTILITIES

MISS DIG/UNDERGROUND UTILITY NOTIFICATION

For the protection of underground utilities and in conformance with Public Act 174 of 2013, the Contractor shall contact MISS DIG System, Inc. by phone at 811 or 800-482-7171 or via the web at either elocate.missdig.org for single address or rte.missdig.org, a minimum of 3 work days prior to excavating, excluding weekends and holidays.

ROW / REAL ESTATE

LAWN SPRINKLER SYSTEMS AND LANDSCAPING

Owners of existing lawn sprinkler systems and/or landscaping shall be notified in advance of any work to be done that will affect those systems and/or landscaping. If the property owner fails to relocate the lawn sprinkler system prior to the Contractor beginning work, the Contractor shall carefully salvage the landscaping items and stockpile them on the property owner's property for the property owner. If the Contractor cuts the system during the construction, the Contractor shall cap the system pipe and witness the location of the cap with a wooden stake.

DRAINAGE

ILLCIT CONNECTIONS TO STORM WATER SYSTEM

Connections to existing storm conveyance systems not shown on the plans must be reconnected with minimal interruption in service. Size, type and location by station and offset of any suspect illicit discharge observed shall be reported to the Engineer prior to reconnecting. Contractor shall proceed as directed by the Engineer.

EARTHWORK

SOIL EROSION MEASURES

Appropriate soil erosion and sedimentation control measures shall be in place prior to earth-disturbing activities. Place turf establishment items as soon as possible on potential erodable slopes as directed by the Engineer.

BASES

AGGREGATE BASE

Aggregate bases shall be 21AA in accordance with the MDOT 2020 Standard Specifications for Construction.

PAVEMENT

SOIL BORINGS AND/OR PAVEMENT CORES

The soil boring logs and/or pavement cores represent point information. No inference should be made that subsurface or pavement conditions are the same at other locations.

CONCRETE

The type of concrete to be used on this project is Type P1.

LANDSCAPING

All equipment to be used must be approved by the Engineer prior to beginning work.

Storage of equipment and materials will be restricted to areas designated by the Owner.

Branches of all trees to be saved shall not be removed, or damaged by construction equipment. If removal of lower branches is necessary, contact DPW for proper methods.

Contractor shall promptly restore any property damage at no expense to the Owner.

All excavated material will become the property of the Contractor. Any excavated material not used on the project shall be removed from the site and disposed of in accordance with Section 205.03.P. of the 2020 Standard Specification for Construction and any applicable state and/or local ordinances.

No cereal rye seeding shall be used on this project.

SIGNS

GENERAL

All signs shall be installed, removed and/or salvaged according to the current edition of "Michigan Manual on Uniform Traffic Control Devices" and the current edition of Michigan Department of Transportation (MDOT) "Standard Specifications for Construction."

All signs on the plans or in the log that do not have a recommendation are to be retained.

EXISTING SIGN RELOCATION

Any permanent signs requiring relocation due to Contractor operations shall be salvaged and reset by the Contractor at locations designated by the Engineer. Signs and posts damaged during the removal and storage operations shall be replaced with new signs and posts. The cost of this work shall be borne by the Contractor.

NOTES APPLYING TO STANDARD PLANS

Where the following items are called for on plans, they are to be constructed according to the standard plan series given below opposite each item unless otherwise indicated.

Title	Plan Series
SIDEWALK RAMP AND DETECTABLE WARNING DETAILS	R-28*
DRIVEWAY OPENINGS & APPROACHES AND CONCRETE SIDEWALK	R-29
SOIL EROSION & SEDIMENTATION CONTROL MEASURES	R-96

* Denotes Special Detail

PUBLIC UTILITIES

The existing utilities listed below and locations of utilities as shown on the plans represent the best information available at the time these plans were prepared. This information does not relieve the contractor of the responsibility to satisfy himself as to their accuracy or of his responsibility to verify all existing utilities within the C.I.A. In case utilities have been constructed or removed since the topographic survey was prepared.

NAME OF OWNER

DETROIT EDISON CO.
TOM KOCH
ONE ENERGY PLAZA
2045 WEB
DETROIT, MI 48226
(313) 235-4432

D.T.E. COMMUNITY LIGHTING
DEBRA CAIN
(313) 618-6996

D.T.E. GAS COMPANY
BASEL DSAZMATI
17150 ALLEN ROAD
MELVINDALE, MICHIGAN 48122
(248) 825-4636

A.T.&T.
ENGINEERING DEPARTMENT
100 S. MAIN ST., SUITE 314
MT. CLEMENS, MICHIGAN 48043
(586) 466-1024

COMCAST CABLE
WARREN SETTY
6095 WALL STREET
STERLING HEIGHTS, MICHIGAN 48312
(586) 883-7253

WAYNE COUNTY DEPARTMENT OF SERVICES
PETE MILENKOVICH
29900 GODDARD ROAD
DETROIT, MICHIGAN 48241
(734) 955-2154

CITY OF GROSSE POINTE WOODS DEPARTMENT OF PUBLIC WORKS
JIM KOWALSKI
1200 PARKWAY
GROSSE POINTE WOODS, MICHIGAN 48236
(313) 343-2460

UTILITY

POWER & ELECTRIC

STREET LIGHTS

GAS

TELEPHONE & OTHER COMMUNICATION SYSTEMS

CABLE TV

TRAFFIC SIGNALS

WATER / SEWER

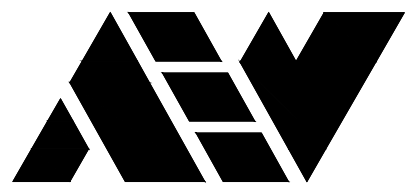

ANDERSON, ECKSTEIN AND WESTRICK, INC.

CIVIL ENGINEERS SURVEYORS ARCHITECTS

51301 Schoenherr Road Phone 586 726 1234
Shelby Township Michigan 48315 Fax 586 726 8780

www.aewinc.com

ENGINEERING STRONG COMMUNITIES

DATE	SUBMITTALS/REVISIONS
PROJECT NAME:	

Ghesquiere Park Walking Path

SHEET TITLE:

NOTE SHEET

CLIENT:
CITY OF GROSSE POINTE WOODS

<input checked="" type="checkbox"/> PRELIMINARY	<input type="checkbox"/> CONSTRUCTION	<input type="checkbox"/> RECORD
DRAWN BY: JPB	CHECKED BY: RTW	DATE: NOVEMBER 2024
SCALE: NOT TO SCALE		

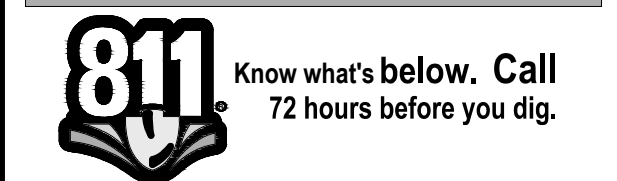

UTILITY INFORMATION, AS SHOWN, INDICATES APPROXIMATE LOCATIONS AND TYPES OF EXISTING FACILITIES ONLY, AS DISCLOSED BY RECORDS PROVIDED TO THIS FIRM FROM THE VARIOUS UTILITY COMPANIES. NO GUARANTEE IS GIVEN OR IMPLIED AS TO THE COMPLETENESS OR ACCURACY THEREOF.

PRIOR TO CONSTRUCTION, ALL LOCATIONS AND DEPTHS OF EXISTING OVERHEAD AND UNDERGROUND UTILITIES (IN CONFLICT WITH THE CONSTRUCTION OF THESE PROPOSED IMPROVEMENTS) SHALL BE VERIFIED IN THE FIELD. DURING THE CONSTRUCTION, THE CONTRACTOR SHALL PROTECT AND SUPPORT ALL UTILITIES THAT ARE ENCOUNTERED. (CALL COSTS FOR UTILITY LOCATION VERIFICATION, SUPPORT AND PROTECTION SHALL BE INCLUDED IN THE PROPOSED PAY ITEM CONFLICTING WITH THAT UTILITY).

DURING CONSTRUCTION, THE CONTRACTOR SHALL USE EXTREME CAUTION WHEN OPERATING NEAR ANY AND ALL OVERHEAD AND / OR BURIED UTILITIES.

PROJECT NO. 0160-0482

M:\0160\0482\CAD\DRAWINGS\CONSTRUCTION\CIVIL\01_CONSTR.PLAN.DWG
02_Notes-11/26/2024 8:33:53 AM

SHEET NO.

2



ANDERSON, ECKSTEIN AND WESTRICK, INC.

CIVIL ENGINEERS SURVEYORS ARCHITECTS

51301 Schoenherr Road Phone 586 726 1234
Shelby Township Michigan 48315 Fax 586 726 8780

www.aewinc.com

ENGINEERING STRONG COMMUNITIES

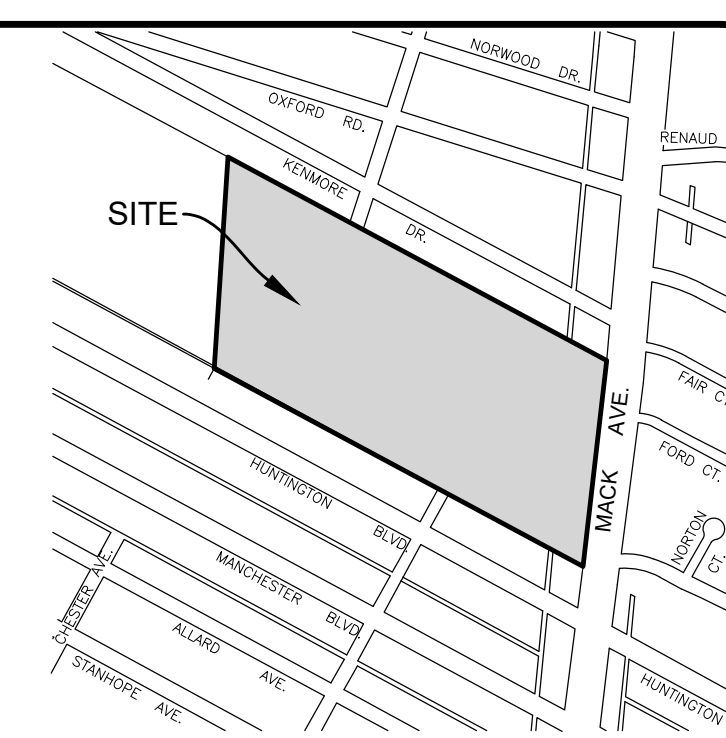

LOCATION MAP

HMA APPLICATION ESTIMATE

IDENT NO	PAY ITEM	RATE LBS SQ YD	PERFORMANCE GRADE	COMMENTS
36A	HMA, 36A	165	58-22	TOP COURSE
4EML	HMA, 4EML	165	58-22	BASE COURSE

* FOR INFORMATION ONLY (PAYMENT FOR BOND COATS SHALL BE INCLUDED IN HMA MIXTURES)

- NOTES:
- HMA MIXTURES SHALL BE PLACED IN LIFTS WHICH DO NOT EXCEED THE MAXIMUM HMA APPLICATION RATES IN SECTION 501 OF THE STANDARD SPECIFICATIONS FOR CONSTRUCTION.
 - BOND COATS SHALL BE SS-1H AND SHALL BE APPLIED AT A RATE OF 0.05 GAL/SQUARE YARD BETWEEN LIFTS.

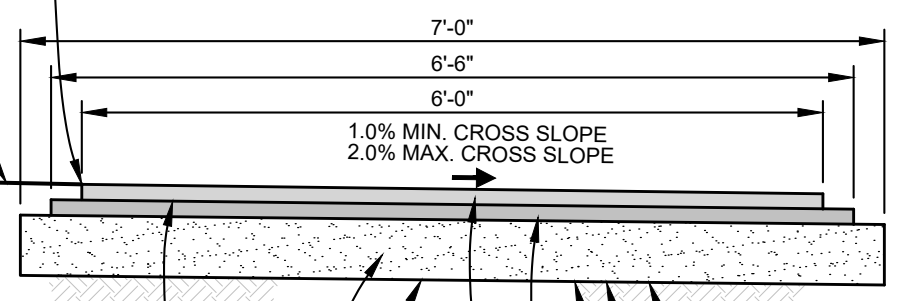

WALKING PATH DETAIL
NOT TO SCALE

PLAN GRADE (AT HIGH POINT)
PLACE SUITABLE MATERIAL TO PROVIDE A GRADUAL TRANSITION TO EXISTING GRADE, WITH APPROVAL OF ENGINEER, INCLUDED IN 'Embankment, CIP'

CAUTION: HAND DIG NEAR EXISTING STORM TO VERIFY DEPTH.

Curb Ramp, Conc, 8 inch AND Detectable Warning Surface

BOND COAT SS-1H BETWEEN WEARING AND LEVELING COURSES @ 0.05 GAL/SYD.

8\"/>

EX. TOPSOIL LAYER VARIES IN THICKNESS (SEE SOIL BORING LOGS)

SUBGRADE COMPACTED TO 95% MAXIMUM DRY DENSITY AND TREATED WITH SOIL STERILANT

REMOVE UNSUITABLE MATERIAL ABOVE THIS LINE AND PREPARE THE SUBGRADE AS PER THE SPECIAL PROVISION, INCLUDED IN 'Station Grading'.

REMOVE UNSUITABLE MATERIAL BELOW THIS LINE AND PREPARE THE SUBGRADE WITH APPROVAL OF ENGINEER, INCLUDED IN 'Subgrade Undercutting, Type IV'.

NOTES:

- NO ATTEMPT IS MADE TO STIPULATE EVERY REQUIRED ITEM OF REMOVAL AND DEMOLITION EITHER ON DRAWINGS OR IN SPECIFICATIONS. VISIT THE SITE AND STUDY EXISTING PHYSICAL CONDITIONS, REVIEW DRAWINGS, AND REACH CONCLUSIONS ON WORK NECESSARY TO ACCOMPLISH INTENDED RESULTS DESCRIBED BY THE PROJECT DOCUMENTS.
- ALL DEMOLITION WORK SHALL CONFORM TO GOVERNING AGENCY DESIGN STANDARDS AND SPECIFICATIONS. COMPLY WITH OSHA REGULATIONS INsofar AS THEY APPLY TO THE REQUIRED WORK.
- SOIL EROSION AND SILTATION CONTROL MEASURES MUST BE IN PLACE PRIOR TO STARTING EARTH MOVING OPERATIONS. THESE CONTROL MEASURES SHALL CONFORM IN ALL RESPECTS TO GOVERNING AGENCY REQUIREMENTS.
- PROVIDE A DESIGNATED AREA (TO BE APPROVED BY OWNER) FOR STORAGE OF MATERIALS, EQUIPMENT AND PARKING OF THE REQUIRED EQUIPMENT. DESIGNATE A TRAFFIC LANE FOR INGRESS AND EGRESS FROM THE WORK AREA. IF REQUIRED, PROVIDE FLAG MEN FOR A SAFE AND EFFICIENT MOVEMENT OF VEHICLES. NO CHANGES TO THE WORK AREA OR TO THE AGREED TRAFFIC PATTERN SHALL BE MADE WITHOUT PRIOR APPROVAL OF THE OWNER CONSTRUCTION MANAGER. THE CONSTRUCTION MANAGER WILL SECURE THE APPROVAL FOR SUCH CHANGES.
- COMPLETELY RESTORE ALL DISTURBED AREAS TO A CONDITION EQUAL TO OR BETTER THAN EXISTING CONDITION AND TO THE SATISFACTION OF THE OWNER AND MUNICIPALITY. ALL COSTS FOR CLEAN-UP, RESTORATION WORK AND OTHER IMMEDIATE OPERATIONS SUCH AS, BUT NOT LIMITED TO, CONSTRUCTION SIGNAGE, STREET SWEEPING AND MAINTAINING EXISTING UTILITIES SHALL BE THE CONTRACTOR'S RESPONSIBILITY. PERFORM RESTORATION WORK WITHIN 5 DAYS AFTER COMPLETION OF FINAL GRADING.
- WHERE EXISTING PAVEMENT IS TO BE PARTIALLY REMOVED, SAWCUT PAVEMENT FULL DEPTH TO PROVIDE A SMOOTH JOINT WITH PROPOSED PAVEMENT.
- REMOVE ALL EXISTING UTILITY PIPING SERVICES WITHIN THE DESIGNATED WORK AREA UNLESS OTHERWISE INDICATED ON THE PLANS. DISCONNECT FROM PUBLIC UTILITIES IN ACCORDANCE WITH UTILITY OWNER'S REQUIREMENTS.
- PROMPTLY REMOVE ALL DEMOLITIONS, REMOVALS, RUBBISH, AND DEBRIS FROM THE LIMITS OF THE OWNER'S PROPERTY AND DISPOSE IN A LEGAL MANNER.
- EXCAVATIONS AND HAZARDOUS AREAS SHALL BE PROTECTED BY BARRICADES. BARRICADES LEFT IN PLACE AT NIGHT SHALL BE LIGHTED.
- RESTORE AT CONTRACTOR'S EXPENSE ANY STRUCTURES, PIPE, UTILITY, PAVEMENT, CURBS, SIDEWALKS, LANDSCAPED AREAS, ETC. WITHIN THE SITE OR ADJOINING PROPERTIES DISTURBED DURING DEMOLITION OR CONSTRUCTION TO THEIR ORIGINAL CONDITION OR BETTER, AND TO THE SATISFACTION OF THE OWNER AND LOCAL MUNICIPALITY. ALL WORK WITHIN A D.O.T RIGHT-OF-WAY SHALL COMPLY WITH ALL D.O.T STANDARDS.
- THE WORK INCLUDED SHALL BE PERFORMED AS INDICATED ON THE PLANS. STOCKPILING, STORAGE OF MATERIALS AND ACCESS TO THE SITE SHALL BE COORDINATED WITH THE OWNER.
- PRESERVE ALL SURVEY STAKES AND PROPERTY LINE MONUMENTS. ANY STAKES OR MONUMENTS DESTROYED OR DISTURBED IN THE COURSE OF WORK SHALL BE RESTORED OR REPLACED AT THE CONTRACTOR'S EXPENSE.
- ALL EXCAVATION IS CONSIDERED UNCLASSIFIED. THE CONTRACTOR SHALL BE RESPONSIBLE FOR ALL MEANS, METHODS, AND MATERIALS OF CONSTRUCTION TO COMPLETE CONSTRUCTION AS DESIGNED. ADDITIONALLY, THE CONTRACTOR SHALL BE RESPONSIBLE FOR THE OFF-SITE DISPOSAL OF ANY AND ALL EXCESS OR UNSUITABLE MATERIAL AND THE IMPORTATION OF ANY BORROW MATERIAL NECESSARY TO COMPLETE THE JOB.
- OWNER RESERVES THE RIGHT TO SALVAGE EXISTING MATERIALS. COORDINATE DISPOSAL OF MATERIALS WITH OWNER.
- BACKFILL TRENCHES RESULTING FROM UNDERGROUND UTILITY REMOVAL WITH CL-1 SAND COMPACTED TO 95% MAX. UNIT WEIGHT.

LEGEND

- HMA, 36A (1.5") ON
- HMA, 4EML (1.5") ON
- Aggregate Base, 6 inch
- Curb Ramp, Conc, 8 inch

ESTIMATED QUANTITIES (STATION 10+00 TO 17+00)

1. Tree, Rem, 6 inch to 18 inch	3 Ea
2. Station Grading	6.5 Sta
3. Aggregate Base, 8 inch	508 Syd
4. HMA, 36A	36 Ton
5. HMA, 4EML	39 Ton
6. Detectable Warning Surface	6 Ft
7. Curb Ramp, Conc, 8 inch	66 Sft

ESTIMATED QUANTITIES (STATION 20+00 TO 40+00)

1. Station Grading	19.4 Sta
2. Aggregate Base, 8 inch	1,505 Syd
3. HMA, 36A	107 Ton
4. HMA, 4EML	116 Ton
5. Detectable Warning Surface	6 Ft
6. Curb Ramp, Conc, 8 inch	60 Sft

ESTIMATED QUANTITIES (STATION 50+00 TO 53+00)

1. Station Grading	2.2 Sta
2. Aggregate Base, 8 inch	168 Syd
3. HMA, 36A	10 Ton
4. HMA, 4EML	10 Ton

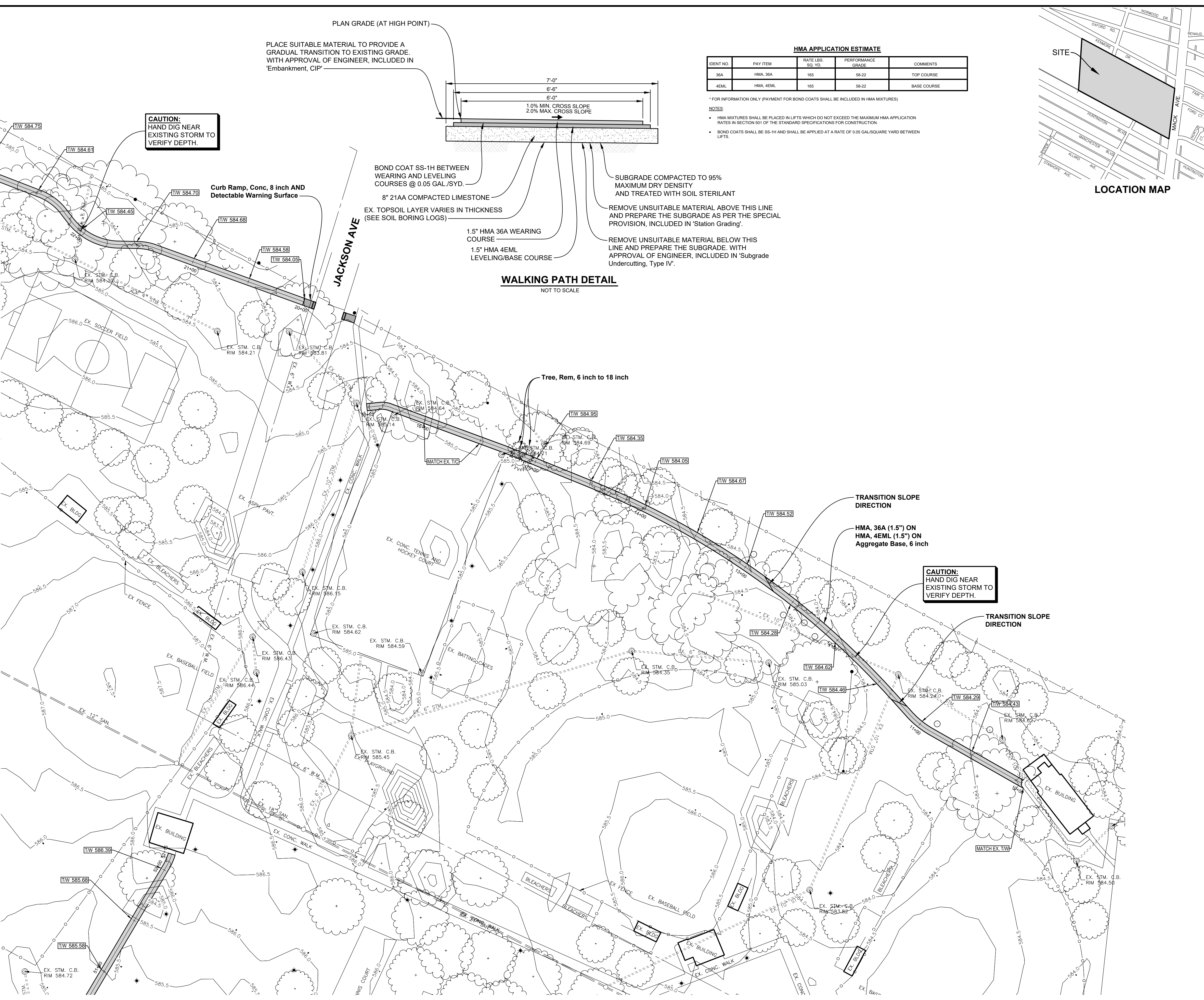

CAUTION: HAND DIG NEAR EXISTING STORM TO VERIFY DEPTH.

TRANSITION SLOPE DIRECTION

HMA, 36A (1.5") ON
HMA, 4EML (1.5") ON
Aggregate Base, 6 inch

TRANSITION SLOPE DIRECTION

DATE	SUBMITTALS/REVISIONS

PROJECT NAME:

Ghesquiere Park Walking Path

SHEET TITLE:

CONSTRUCTION & GRADING PLAN

CLIENT: CITY OF GROSSE POINTE WOODS

PRELIMINARY	CONSTRUCTION	RECORD
<input type="checkbox"/>	<input type="checkbox"/>	<input type="checkbox"/>

DRAWN BY: JPB CHECKED BY: RTW DATE: NOVEMBER 2024

SCALE: 1" = 40' HORIZ.

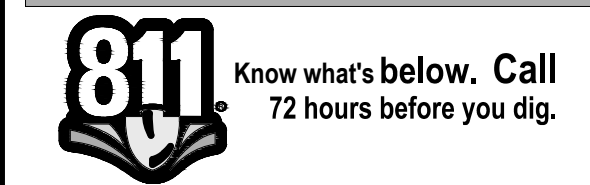

UTILITY INFORMATION, AS SHOWN, INDICATES APPROXIMATE LOCATIONS AND TYPES OF EXISTING FACILITIES ONLY. AS DISCLOSED BY RECORDS PROVIDED TO THIS FIRM FROM THE VARIOUS UTILITY COMPANIES. NO GUARANTEE IS GIVEN OR IMPLIED AS TO THE COMPLETENESS OR ACCURACY THEREOF.

PRIOR TO CONSTRUCTION, ALL LOCATIONS AND DEPTHS OF EXISTING OVERHEAD AND UNDERGROUND UTILITIES (IN CONFLICT WITH THE CONSTRUCTION OF THESE PROPOSED IMPROVEMENTS) SHALL BE VERIFIED IN THE FIELD. DURING THE CONSTRUCTION, THE CONTRACTOR SHALL PROTECT AND SUPPORT ALL UTILITIES THAT ARE ENCOUNTERED. (CALL COSTS FOR UTILITY LOCATION VERIFICATION, SUPPORT AND PROTECTION SHALL BE INCLUDED IN THE PROPOSED PAY ITEM CONFLICTING WITH THAT UTILITY).

DURING CONSTRUCTION, THE CONTRACTOR SHALL USE EXTREME CAUTION WHEN OPERATING NEAR ANY AND ALL OVERHEAD AND / OR BURIED UTILITIES.

PROJECT NO. 0160-0482

M:\0160\0482\CAD\DRAWINGS\CONSTRUCTION\CIVIL\01_CONSTRPLANS.DWG
03_Constr-11/26/2024 8:34:01 AM

SHEET NO.

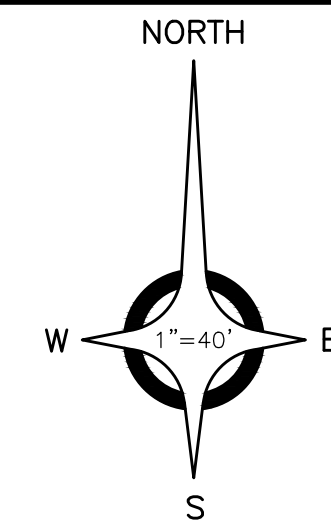

GENERAL CONSTRUCTION NOTES:

1. THE CONTRACTOR AT ALL TIMES SHALL FOLLOW ALL FEDERAL, STATE AND LOCAL SAFETY REQUIREMENTS DURING CONSTRUCTION OF THIS PROJECT. SPECIAL CARE SHALL BE TAKEN DURING ALL TRENCHING OPERATIONS. SHEETING AND BRACING, CRIBBING, ETC., MUST BE INSTALLED AS REQUIRED TO PROVIDE MAXIMUM SAFETY TO THE CONTRACTORS WORKERS IN FULL COMPLIANCE WITH OSHA REGULATIONS.
2. ALL CONSTRUCTION SHALL BE CONDUCTED SUCH THAT THERE WILL BE MINIMAL INTERFERENCE WITH STREETS, DRIVES OR WALKS. THE CONTRACTOR IS RESPONSIBLE FOR MAINTENANCE OF TRAFFIC, DO NOT CLOSE OR OBSTRUCT STREETS, DRIVES OR WALKS OR USER FACILITIES WITHOUT PERMISSION FROM THE OWNER'S REPRESENTATIVE.
3. CONTRACTOR SHALL KEEP EXISTING STREETS, ROADS AND DRIVES CLEAR OF DIRT, DEBRIS AND EQUIPMENT.
4. CONTRACTOR SHALL BE RESPONSIBLE FOR SHORING AND FOR DEWATERING TO ACCOMPLISH ALL WORK INDICATED ON PLANS AND TO PERFORM REQUIRED COMPACTION OPERATIONS.
5. REVIEW CONSTRUCTION AND PROVIDE TRAFFIC SEQUENCE AND SCHEDULE AT THE PRECONSTRUCTION MEETING WITH OWNER.
6. THE CONTRACTOR SHALL VERIFY ALL SITE CONDITIONS IN THE FIELD AND CONTACT THE ENGINEER IF THERE ARE ANY QUESTIONS OR CONFLICTS REGARDING THE CONSTRUCTION DOCUMENTS AND/OR FIELD CONDITIONS SO THAT APPROPRIATE REVISIONS CAN BE MADE PRIOR TO CONSTRUCTION. ANY CONFLICT BETWEEN DRAWINGS AND THE SPECIFICATIONS SHALL BE CONFIRMED WITH THE ENGINEER PRIOR TO BIDDING.
7. THE CONTRACTOR SHALL ABIDE BY ALL OSHA, FEDERAL, STATE AND LOCAL REGULATIONS WHEN OPERATING CRANES, BOOMS, HOISTS, ETC. IN CLOSE PROXIMITY TO OVERHEAD ELECTRIC LINES. IF CONTRACTOR MUST OPERATE EQUIPMENT CLOSE TO ELECTRIC LINES, CONTACT THE POWER COMPANY TO MAKE ARRANGEMENTS FOR PROPER SAFEGUARDS.
8. THE OWNER AT ITS DISCRETION RESERVES THE RIGHT TO MODIFY THE DETAILS AND STANDARDS OF CONSTRUCTION FOR ALL PRIVATE FACILITIES FROM THAT INDICATED ON THE APPROVED PLAN, PROVIDED THAT THE ALTERNATE STANDARD COMPLIES WITH LOCAL CODE AND/OR UTILITY COMPANY REQUIREMENTS AND THE GENERAL DESIGN INTENT OF THE PROJECT IS NOT COMPROMISED.
9. CONTRACTOR SHALL MAINTAIN ALL TRAFFIC LANES AND PEDESTRIAN WALKWAYS AT ALL TIMES UNLESS WRITTEN APPROVAL FROM THE STATE DOT, LOCAL MUNICIPALITY, COUNTY, OR OTHER GOVERNING AUTHORITY IS RECEIVED.
10. THE CONTRACTOR SHALL NOTIFY THE ENGINEER SHOULD ANY DISCREPANCY REGARDING THE PROPOSED WORK OR UNFORESEEN CONDITIONS ARISE PRIOR TO PROCEEDING FURTHER WITH THE AFFECTED WORK.
11. THE CONTRACTOR SHALL PROVIDE AS-BUILT RECORDS OF ALL CONSTRUCTION (INCLUDING UNDERGROUND UTILITIES) TO THE ENGINEER AND OWNER FOLLOWING COMPLETION OF CONSTRUCTION ACTIVITIES.
12. ALL PAVING AND AGGREGATE MATERIALS AND WORK COMPLETED SHALL BE IN STRICT ACCORDANCE WITH THE STATE DOT SPECIFICATIONS AND STANDARD DETAILS UNLESS OTHERWISE SPECIFIED.
13. THE CONTRACTOR SHALL BE RESPONSIBLE FOR VERIFYING ALL DIMENSIONS FOR BUILDING, WALLS, CONCRETE SLABS, AND UTILITY SERVICE POINT CONNECTIONS AND NOTIFYING THE OWNER AND ENGINEER OF ANY CONFLICTS OR DISCREPANCIES PRIOR TO CONSTRUCTION.
14. THE CONTRACTOR SHALL SUBMIT SHOP DRAWINGS OF ALL PRODUCTS AND MATERIALS TO THE OWNER AND LOCAL UTILITY COMPANIES AS REQUIRED FOR REVIEW AND APPROVAL PRIOR TO FABRICATION OR DELIVERY TO THE SITE. ALLOW A MINIMUM OF 7 DAYS FOR REVIEW.
15. THE CONTRACTOR SHALL REFERENCE ARCHITECTURAL PLANS FOR EXACT DIMENSIONS AND CONSTRUCTION DETAILS OF BUILDING, CANOPY, AND UTILITY CONNECTIONS.
16. TRAFFIC CONTROL SIGNAGE SHALL CONFORM TO THE STATE DOT STANDARD DETAIL SHEETS AND THE MANUAL OF UNIFORM TRAFFIC CONTROL DEVICES. SIGNS SHALL BE INSTALLED PLUMB.
17. FIRE LANES SHALL BE ESTABLISHED AND PROPERLY DESIGNATED IN ACCORDANCE WITH THE LOCAL MUNICIPALITY AND LOCAL FIRE DEPARTMENT REQUIREMENTS.
18. THE CONTRACTOR SHALL REMOVE CONFLICTING PAVEMENT MARKINGS IN A METHOD APPROVED BY THE STATE DOT.
19. AGGREGATES AND BITUMINOUS PAVEMENT MATERIAL AND INSTALLATION SPECIFICATIONS SHALL BE IN ACCORDANCE WITH STATE DOT SPECS. THE CONTRACTOR SHALL SUBMIT AGGREGATE SIEVE ANALYSIS AND A JOB-MIX FORMULA FOR THE BITUMINOUS PAVEMENT TO THE CONSTRUCTION MANAGER FOR REVIEW AND APPROVAL AT LEAST 14 DAYS PRIOR TO THE PLACEMENT OF BITUMINOUS PAVEMENTS.
20. ALTERNATIVE METHODS AND PRODUCTS OTHER THAN THOSE SPECIFIED MAY BE USED IF REVIEWED AND APPROVED BY THE OWNER, ENGINEER, AND APPROPRIATE REGULATORY AGENCIES PRIOR TO INSTALLATION.
21. CONTRACTOR SHALL BE RESPONSIBLE FOR ALL CONSTRUCTION LAYOUTS AND SURVEYS REQUIRED TO PERFORM CONSTRUCTION. CADD FILE INFORMATION IS PROVIDED FOR REFERENCE ONLY.
22. PROVIDE ADEQUATE BARRICADES AT DRIVES, ENTRANCES, EXCAVATIONS AND OTHER OPENINGS TO KEEP OUT UNAUTHORIZED PERSONS AND FOR PUBLIC SAFETY AND TRAFFIC CONTROL. SAFETY PROVISIONS OF APPLICABLE LAWS SHALL BE OBSERVED AT ALL TIMES. BARRICADES LEFT IN PLACE AT NIGHT SHALL BE LIGHTED.
23. NO EQUIPMENT OR MATERIAL STORAGE IS PERMITTED WITHIN THE ROAD RIGHT-OF-WAY.
24. CONTRACTOR'S MANNER AND METHOD OF INGRESS AND EGRESS WITH RESPECT TO THE PROJECT AREA SHALL IN NO WAY PROHIBIT OR DISTURB NORMAL PEDESTRIAN OR VEHICULAR TRAFFIC IN THE VICINITY AND IS SUBJECT TO REGULATION AND WRITTEN APPROVAL OF APPROPRIATE GOVERNING AGENCIES.
25. CONSTRUCTION SHALL BE IN ACCORDANCE WITH A.D.A. REGULATIONS AS APPLICABLE.



CAUTION:
HAND DIG NEAR
EXISTING STORM TO
VERIFY DEPTH.

CAUTION:
HAND DIG NEAR
EXISTING STORM TO
VERIFY DEPTH.

CAUTION:
HAND DIG NEAR
EXISTING STORM TO
VERIFY DEPTH.

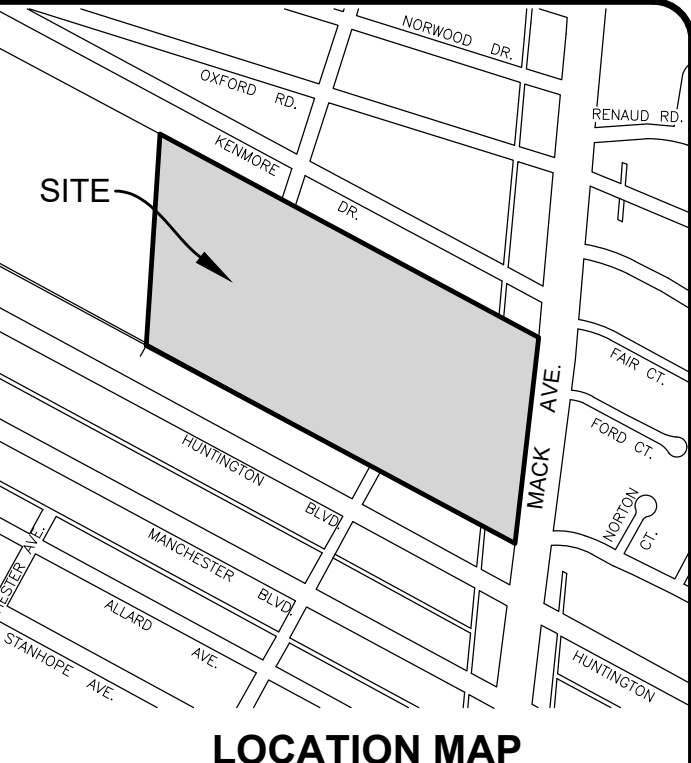

ANDERSON, ECKSTEIN AND WESTRICK, INC.
CIVIL ENGINEERS SURVEYORS ARCHITECTS
51301 Schoenherr Road Phone 586 726 1234
Shelby Township Fax 586 726 8780
Michigan 48315
www.aewinc.com
ENGINEERING STRONG COMMUNITIES

DATE	SUBMITTALS/REVISIONS
PROJECT NAME:	

Ghesquiere Park Walking Path

CONSTRUCTION & GRADING PLAN

CLIENT:
CITY OF GROSE POINTE WOODS

<input checked="" type="checkbox"/> PRELIMINARY	<input type="checkbox"/> CONSTRUCTION	<input type="checkbox"/> RECORD
DRAWN BY: JPB	CHECKED BY: RTW	DATE: NOVEMBER 2024
SCALE: 1" = 40' HORIZ. 0 20 40 80		

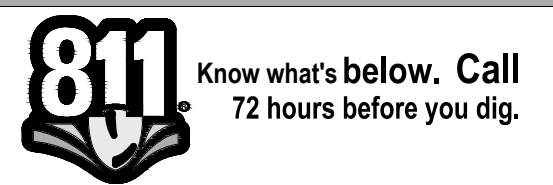

UTILITY INFORMATION, AS SHOWN, INDICATES APPROXIMATE LOCATIONS AND TYPES OF EXISTING FACILITIES ONLY, AS DISCLOSED BY RECORDS PROVIDED TO THIS FIRM FROM THE VARIOUS UTILITY COMPANIES. NO GUARANTEE IS GIVEN OR IMPLIED AS TO THE COMPLETENESS OR ACCURACY THEREOF.

PRIOR TO CONSTRUCTION, ALL LOCATIONS AND DEPTHS OF EXISTING OVERHEAD AND UNDERGROUND UTILITIES (IN CONFLICT WITH THE CONSTRUCTION OF THESE PROPOSED IMPROVEMENTS) SHALL BE VERIFIED IN THE FIELD. DURING THE CONSTRUCTION, THE CONTRACTOR SHALL PROTECT AND SUPPORT ALL UTILITIES THAT ARE ENCOUNTERED. (ALL COSTS FOR UTILITY LOCATION VERIFICATION, SUPPORT AND PROTECTION SHALL BE INCLUDED IN THE PROPOSED PAY ITEM CONFLICTING WITH THAT UTILITY).

DURING CONSTRUCTION, THE CONTRACTOR SHALL USE EXTREME CAUTION WHEN OPERATING NEAR ANY AND ALL OVERHEAD AND / OR BURIED UTILITIES.

PROJECT NO. 0160-0482
M:\0160\0482\CADD\DRAWINGS\CONSTRUCTION\CIVIL\01_CONSTR.PLAN.DWG
04_Constr-11/06/2024 8:34:09 AM
SHEET NO.

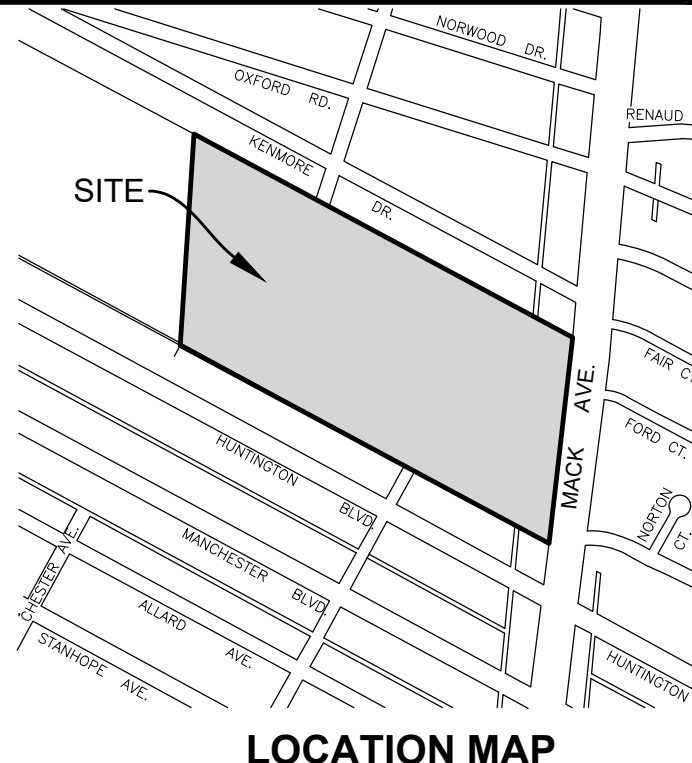
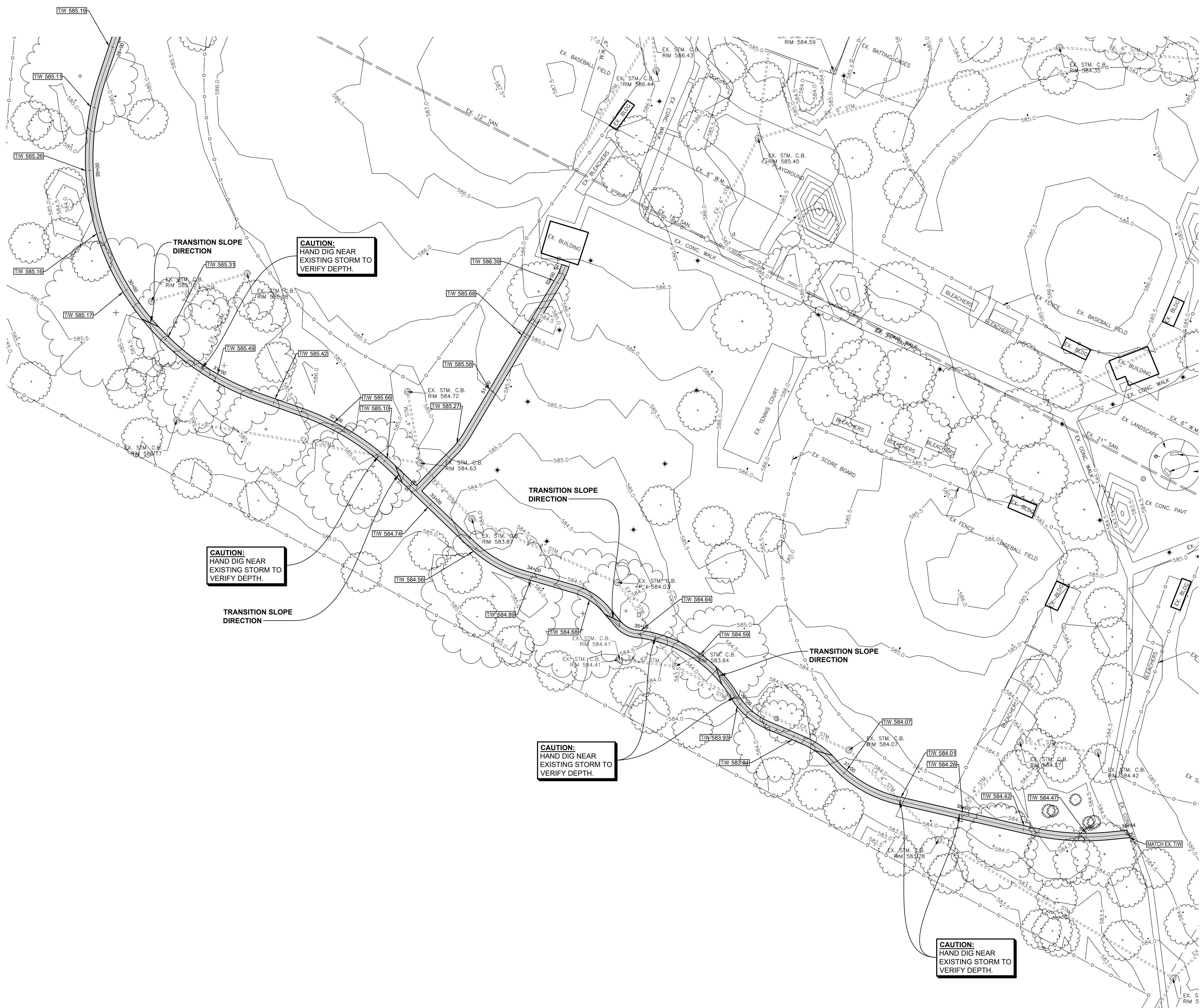
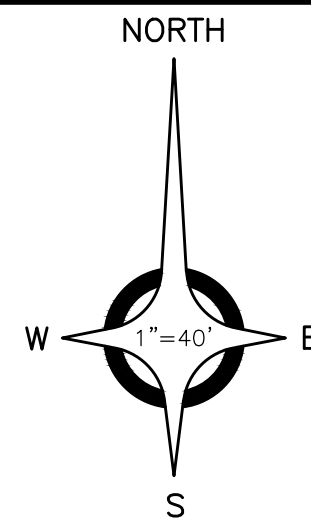

ANDERSON, ECKSTEIN AND WESTRICK, INC.
 CIVIL ENGINEERS SURVEYORS ARCHITECTS
 51301 Schoenherr Road Phone 586 726 1234
 Shelby Township Fax 586 726 8780
 Michigan 48315
 www.aewinc.com
 ENGINEERING STRONG COMMUNITIES

DATE	SUBMITTALS/REVISIONS
PROJECT NAME:	

Ghesquiere Park Walking Path

CONSTRUCTION & GRADING PLAN

CLIENT:
 CITY OF GROSSE POINTE WOODS

<input checked="" type="checkbox"/> PRELIMINARY	<input type="checkbox"/> CONSTRUCTION	<input type="checkbox"/> RECORD
DRAWN BY: JPB	CHECKED BY: RTW	DATE: NOVEMBER 2024
SCALE: 1" = 40' HORIZ. 0 20 40 80		

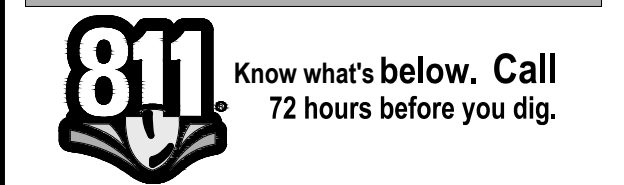

UTILITY INFORMATION, AS SHOWN, INDICATES APPROXIMATE LOCATIONS AND TYPES OF EXISTING FACILITIES ONLY. AS DISCLOSED BY RECORDS PROVIDED TO THIS FIRM FROM THE VARIOUS UTILITY COMPANIES. NO GUARANTEE IS GIVEN OR IMPLIED AS TO THE COMPLETENESS OR ACCURACY THEREOF.

PRIOR TO CONSTRUCTION, ALL LOCATIONS AND DEPTHS OF EXISTING OVERHEAD AND UNDERGROUND UTILITIES (IN CONFLICT WITH THE CONSTRUCTION OF THESE PROPOSED IMPROVEMENTS) SHALL BE VERIFIED IN THE FIELD. DURING THE CONSTRUCTION, THE CONTRACTOR SHALL PROTECT AND SUPPORT ALL UTILITIES THAT ARE ENCOUNTERED. (ALL COSTS FOR UTILITY LOCATION VERIFICATION, SUPPORT AND PROTECTION SHALL BE INCLUDED IN THE PROPOSED PAY ITEM CONFLICTING WITH THAT UTILITY).

DURING CONSTRUCTION, THE CONTRACTOR SHALL USE EXTREME CAUTION WHEN OPERATING NEAR ANY AND ALL OVERHEAD AND / OR BURIED UTILITIES.

PROJECT NO. 0160-0482

M:\0160\0482\CAD\DRAWINGS\CONSTRUCTION\CIVIL\01_CONSTRANS.DWG
 05_Constr-11/26/2024 8:34:16 AM

SHEET NO.

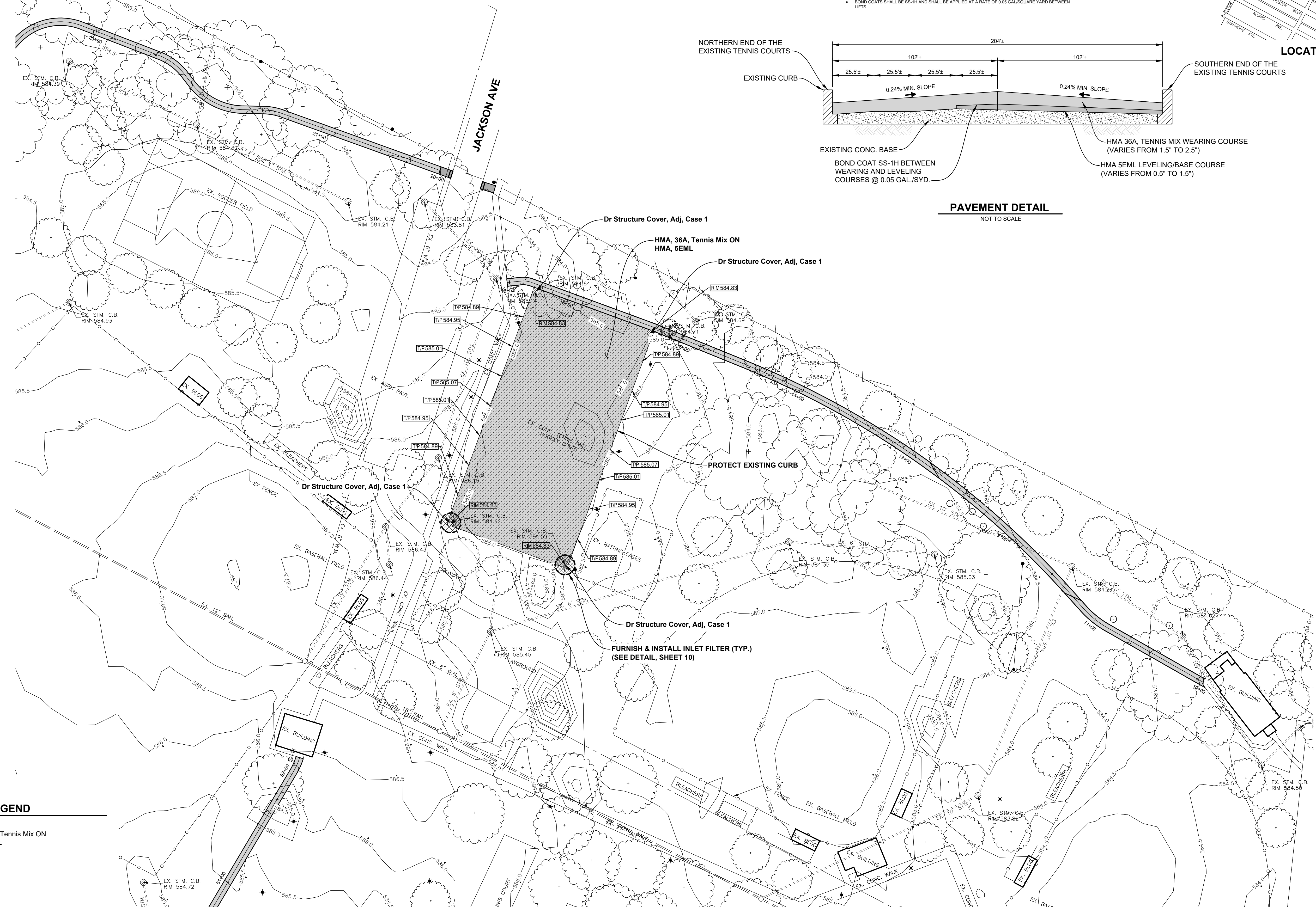
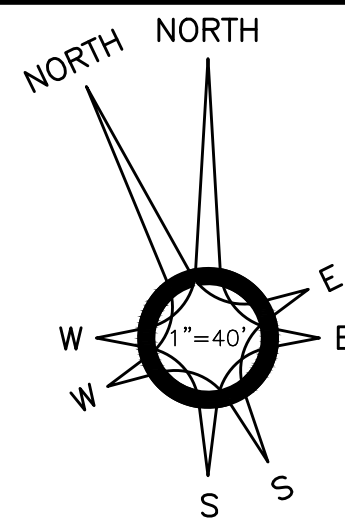

HMA APPLICATION ESTIMATE

IDENT NO.	PAY ITEM	RATE LBS SQ. YD.	PERFORMANCE GRADE	COMMENTS
36A	HMA, 36A, Tennis Mix	VARIABLE	58-22	TOP COURSE
5EML	HMA, 5EML	VARIABLE	58-22	BASE COURSE

* FOR INFORMATION ONLY (PAYMENT FOR BOND COATS SHALL BE INCLUDED IN HMA MIXTURES)

NOTES:

- HMA MIXTURES SHALL BE PLACED IN LIFTS WHICH DO NOT EXCEED THE MAXIMUM HMA APPLICATION RATES IN SECTION 501 OF THE STANDARD SPECIFICATIONS FOR CONSTRUCTION.
- BOND COATS SHALL BE SS-1H AND SHALL BE APPLIED AT A RATE OF 0.05 GAL/SQUARE YARD BETWEEN LIFTS.

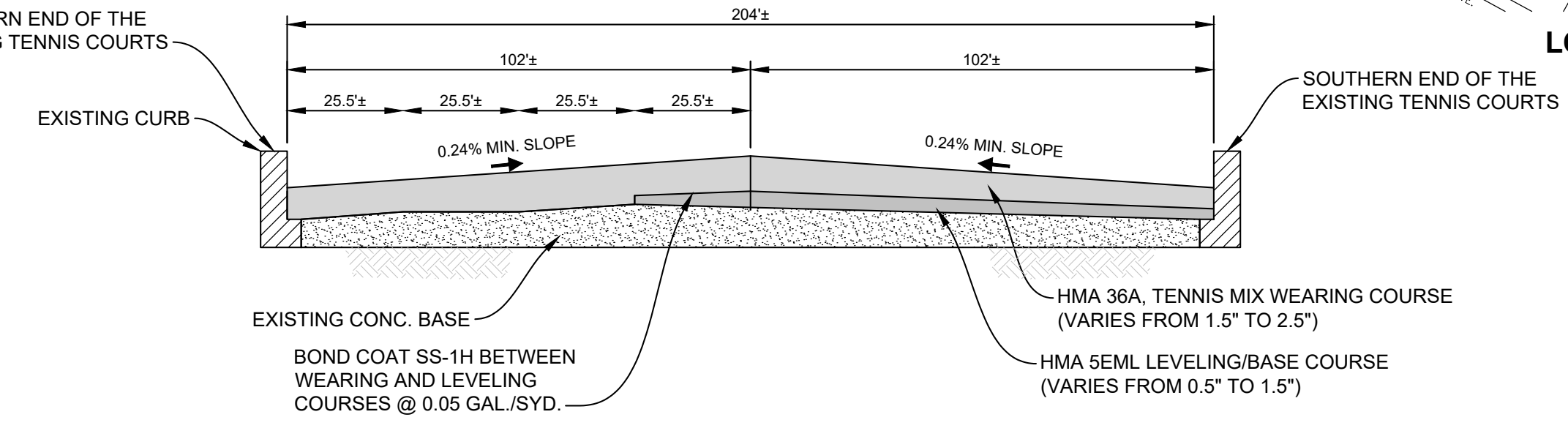

PAVEMENT DETAIL
NOT TO SCALE

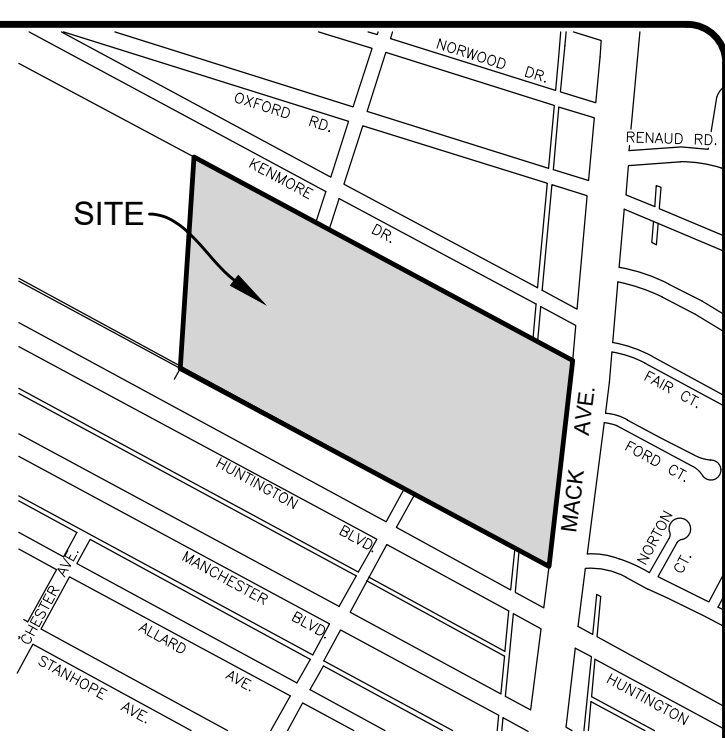

LOCATION MAP

ANDERSON, ECKSTEIN AND WESTRICK, INC.
CIVIL ENGINEERS SURVEYORS ARCHITECTS
51301 Schoenherr Road Phone 586 726 1234
Shelby Township Fax 586 726 8780
Michigan 48315
www.aewinc.com
ENGINEERING STRONG COMMUNITIES

DATE	SUBMITTALS/REVISIONS

PROJECT NAME:

Ghesquiere Park Walking Path

ALTERNATE BID CONSTRUCTION PLAN

CLIENT:
CITY OF GROSSE POINTE WOODS

PRELIMINARY	CONSTRUCTION	RECORD
<input type="checkbox"/>	<input type="checkbox"/>	<input type="checkbox"/>

DRAWN BY:	CHECKED BY:	DATE:
JPB	RTW	NOVEMBER 2024

SCALE: 1" = 40' HORIZ.
0 20 40 80

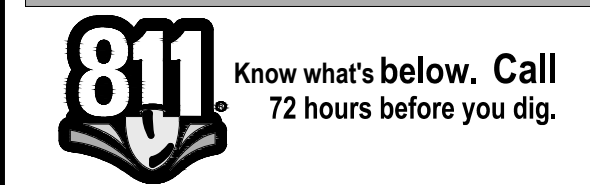

UTILITY INFORMATION, AS SHOWN, INDICATES APPROXIMATE LOCATIONS AND TYPES OF EXISTING FACILITIES ONLY, AS DISCLOSED BY RECORDS PROVIDED TO THIS FIRM FROM THE VARIOUS UTILITY COMPANIES. NO GUARANTEE IS GIVEN OR IMPLIED AS TO THE COMPLETENESS OR ACCURACY THEREOF.

PRIOR TO CONSTRUCTION, ALL LOCATIONS AND DEPTHS OF EXISTING OVERHEAD AND UNDERGROUND UTILITIES (IN CONFLICT WITH THE CONSTRUCTION OF THESE PROPOSED IMPROVEMENTS) SHALL BE VERIFIED IN THE FIELD. DURING THE CONSTRUCTION, THE CONTRACTOR SHALL PROTECT AND SUPPORT ALL UTILITIES THAT ARE ENCOUNTERED. (ALL COSTS FOR UTILITY LOCATION VERIFICATION, SUPPORT AND PROTECTION SHALL BE INCLUDED IN THE PROPOSED PAY ITEM CONFLICTING WITH THAT UTILITY).

DURING CONSTRUCTION, THE CONTRACTOR SHALL USE EXTREME CAUTION WHEN OPERATING NEAR ANY AND ALL OVERHEAD AND / OR BURIED UTILITIES.

PROJECT NO. 0160-0482

M:\0160\0482\CAD\DRAWINGS\CONSTRUCTION\CIVIL\01_CONSTPLANS.DWG
06_Constr-11/26/2024 8:34:24 AM

SHEET NO.

LEGEND

	HMA, 36A, Tennis Mix ON
	HMA, 5EML

ESTIMATED QUANTITIES (THIS SHEET)

1. Erosion Control, Inlet Filter	2 Ea
2. Dr Structure Cover, Adj, Case 1	4 Ea
3. HMA, 5EML	70 Ton
4. HMA, 36A, Tennis Mix	272 Ton



ANDERSON, ECKSTEIN AND WESTRICK, INC.

CIVIL ENGINEERS SURVEYORS ARCHITECTS

51301 Schoenherr Road Phone 586 726 1234
Shelby Township Fax 586 726 8780
Michigan 48315

www.aewinc.com

ENGINEERING STRONG COMMUNITIES

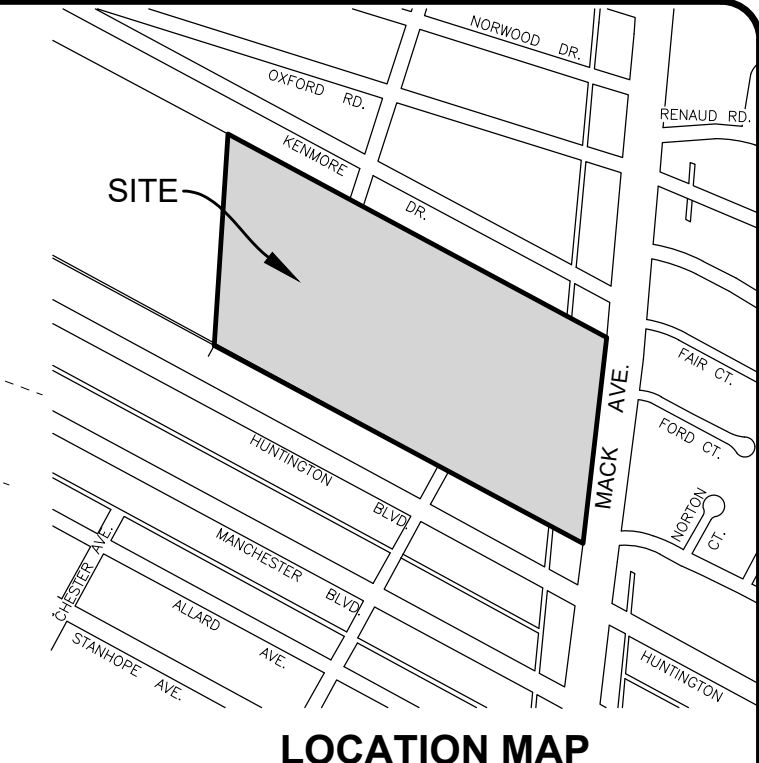
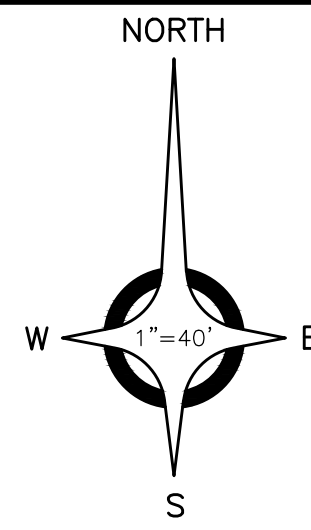

SOILS INFORMATION
AREA OF CONSTRUCTION:
MidaA = Midtown gravelly-artificial sandy loam
UrbarB = Urban land-Riverfront complex, dense substratum
WsnuaA = Wauseon-Urban land complex
ZfsucB = Ziegenfuss-Urban land-Blount complex

- NOTES:**
- SOIL EROSION MEASURES WILL BE INSPECTED, MAINTAINED AND REPAIRED WEEKLY OR AFTER EVERY STORM EVENT AS DIRECTED BY THE ENGINEER.
 - HAUL AND DISPOSE OF EXCESS MATERIAL OFF SITE. NO PERMANENT STOCKPILES WILL BE ALLOWED UNLESS APPROVED BY THE ENGINEER.
 - NO DEWATERING OR ON SITE STOCKPILING OF MATERIAL IS ANTICIPATED ON THIS PROJECT.
 - RESTORE ALL DISTURBED AREAS WITH 3" MIN. TOPSOIL, SEED, FERTILIZER & MULCH INCLUDED IN PAY ITEM 'Site Restoration and Cleanup'.
 - SOIL EROSION CONTACT PERSON: TO BE PROVIDED UPON AWARD OF CONTRACT.
 - DISTANCE TO NEAREST WATER COURSE: MILK RIVER IS 5,800 L.F. ± NORTHEAST OF SITE.
 - GROSS ACREAGE DISTURBED IS 0.45 ACRES.

ESTIMATED QUANTITIES (10+00 TO 17+00)

1. Erosion Control, Inlet Protection, SedCage	3 Ea
2. Erosion Control, Inlet Filter	2 Ea

ESTIMATED QUANTITIES (20+00 TO 40+00)

1. Erosion Control, Inlet Protection, SedCage	16 Ea
---	-------

LEGEND

	EXIST. STORM CATCH BASIN (FIELD)
	EXIST. STORM CATCH BASIN (PAVT.)
	EXIST. STORM MAN HOLE
	STORM MAN HOLE
	STORM CATCH BASIN (FIELD)
	STORM CATCH BASIN (PAVT.)
	INLET FILTER SEDCAGE
	INLET FILTER

DATE	SUBMITTALS/REVISIONS
PROJECT NAME:	

Ghesquiere Park Walking Path

SOIL EROSION & SEDIMENTATION CONTROL PLAN

CLIENT: CITY OF GROSSE POINTE WOODS

<input type="checkbox"/> PRELIMINARY	<input type="checkbox"/> CONSTRUCTION	<input type="checkbox"/> RECORD
DRAWN BY: JPB	CHECKED BY: RTW	DATE: NOVEMBER 2024
SCALE: 1" = 40' HORIZ.		

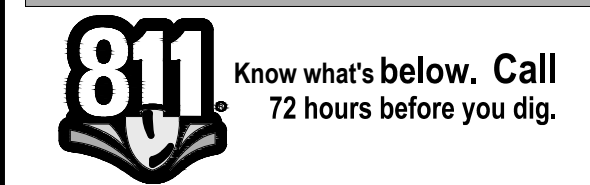

UTILITY INFORMATION, AS SHOWN, INDICATES APPROXIMATE LOCATIONS AND TYPES OF EXISTING FACILITIES ONLY. AS DISCLOSED BY RECORDS PROVIDED TO THIS FIRM FROM THE VARIOUS UTILITY COMPANIES. NO GUARANTEE IS GIVEN OR IMPLIED AS TO THE COMPLETENESS OR ACCURACY THEREOF.

PRIOR TO CONSTRUCTION, ALL LOCATIONS AND DEPTHS OF EXISTING OVERHEAD AND UNDERGROUND UTILITIES (IN CONFLICT WITH THE CONSTRUCTION OF THESE PROPOSED IMPROVEMENTS) SHALL BE VERIFIED IN THE FIELD. DURING THE CONSTRUCTION, THE CONTRACTOR SHALL PROTECT AND SUPPORT ALL UTILITIES THAT ARE ENCOUNTERED. (ALL COSTS FOR UTILITY LOCATION VERIFICATION, SUPPORT AND PROTECTION SHALL BE INCLUDED IN THE PROPOSED PAY ITEM CONFLICTING WITH THAT UTILITY).

DURING CONSTRUCTION, THE CONTRACTOR SHALL USE EXTREME CAUTION WHEN OPERATING NEAR ANY AND ALL OVERHEAD AND / OR BURIED UTILITIES.

PROJECT NO. 0160-0482

M:\0160\0482\CAD\DRAWINGS\CONSTRUCTION\CIVIL\01_CONSTPLANS.DWG
07_SECC-11/26/2024 8:34:32 AM

SHEET NO.

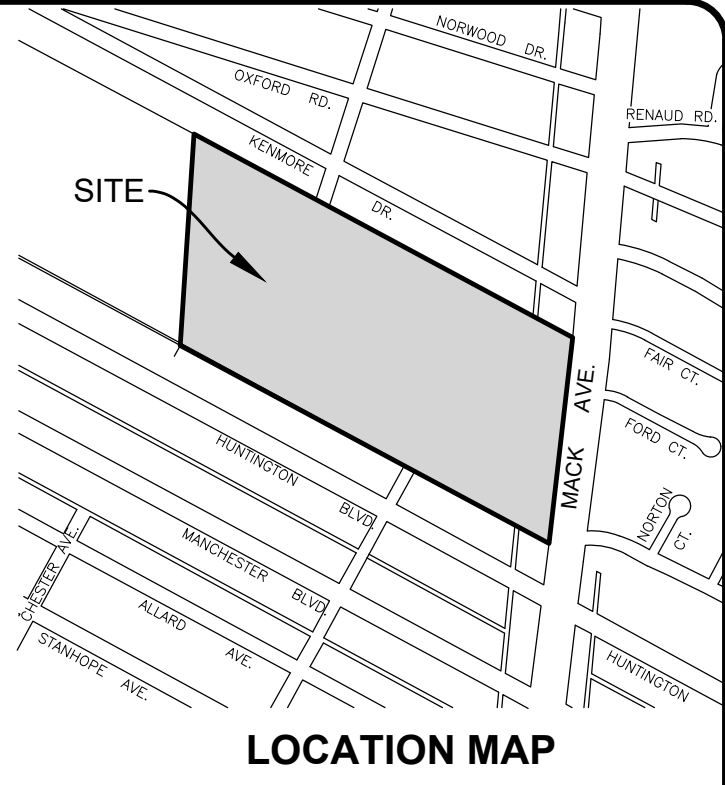
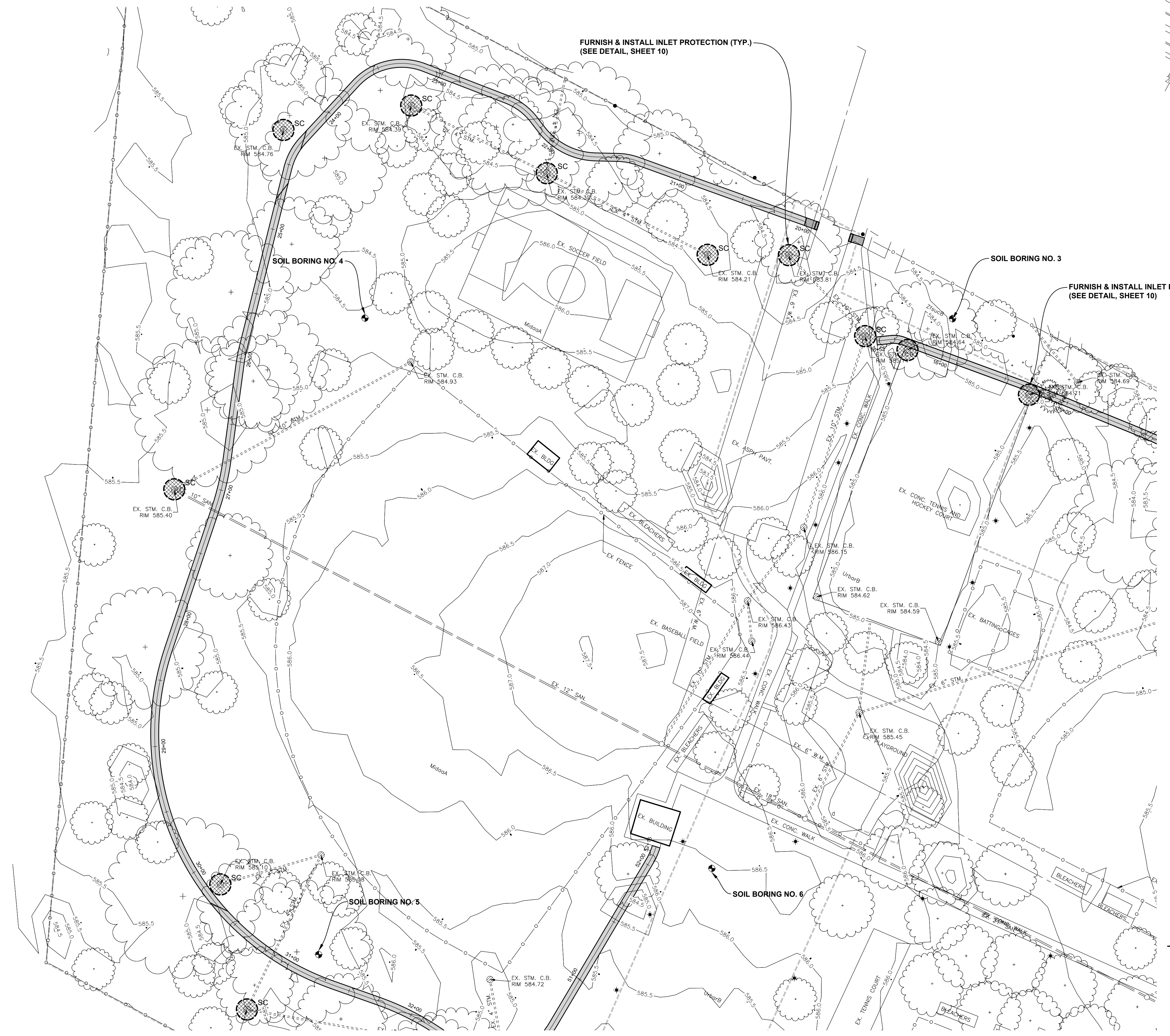
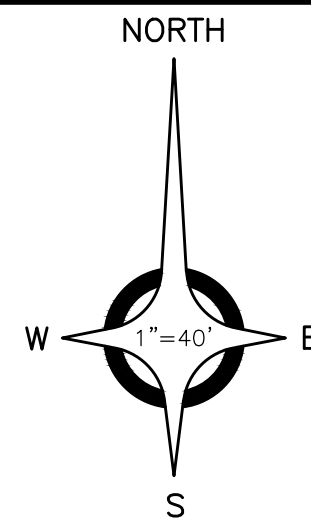

ANDERSON, ECKSTEIN AND WESTRICK, INC.
 CIVIL ENGINEERS SURVEYORS ARCHITECTS
 51301 Schoenherr Road Phone 586 726 1234
 Shelby Township Fax 586 726 8780
 Michigan 48315
 www.aewinc.com
 ENGINEERING STRONG COMMUNITIES

DATE	SUBMITTALS/REVISIONS

PROJECT NAME:

Ghesquiere Park Walking Path

SOIL EROSION & SEDIMENTATION CONTROL PLAN

CLIENT:
CITY OF GROSSE POINTE WOODS

<input checked="" type="checkbox"/>	PRELIMINARY	<input type="checkbox"/>	CONSTRUCTION	<input type="checkbox"/>	RECORD
DRAWN BY:	JPB	CHECKED BY:	RTW	DATE:	NOVEMBER 2024
SCALE: 1" = 40' HORIZ.					
0 20 40 80					

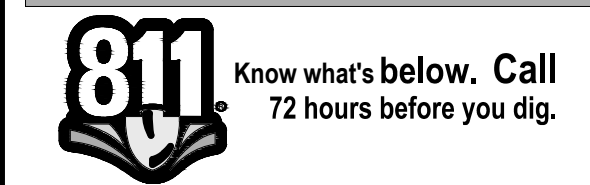

UTILITY INFORMATION, AS SHOWN, INDICATES APPROXIMATE LOCATIONS AND TYPES OF EXISTING FACILITIES ONLY, AS DISCLOSED BY RECORDS PROVIDED TO THIS FIRM FROM THE VARIOUS UTILITY COMPANIES. NO GUARANTEE IS GIVEN OR IMPLIED AS TO THE COMPLETENESS OR ACCURACY THEREOF.

PRIOR TO CONSTRUCTION, ALL LOCATIONS AND DEPTHS OF EXISTING OVERHEAD AND UNDERGROUND UTILITIES (IN CONFLICT WITH THE CONSTRUCTION OF THESE PROPOSED IMPROVEMENTS) SHALL BE VERIFIED IN THE FIELD. DURING THE CONSTRUCTION, THE CONTRACTOR SHALL PROTECT AND SUPPORT ALL UTILITIES THAT ARE ENCOUNTERED. (ALL COSTS FOR UTILITY LOCATION VERIFICATION, SUPPORT AND PROTECTION SHALL BE INCLUDED IN THE PROPOSED PAY ITEM CONFLICTING WITH THAT UTILITY).

DURING CONSTRUCTION, THE CONTRACTOR SHALL USE EXTREME CAUTION WHEN OPERATING NEAR ANY AND ALL OVERHEAD AND / OR BURIED UTILITIES.

- LEGEND**
- EXIST. STORM CATCH BASIN (FIELD)
 - EXIST. STORM CATCH BASIN (PAVT.)
 - EXIST. STORM MAN HOLE
 - STORM MAN HOLE
 - STORM CATCH BASIN (FIELD)
 - STORM CATCH BASIN (PAVT.)
 - INLET FILTER SEDGEA
 - INLET FILTER

PROJECT NO. 0160-0482

M:\0160\0482\CAD\DRAWINGS\CONSTRUCTION\CIVIL\01_CONSTR.PLAN.DWG
 08_SECC-11/26/2024 8:34:39 AM

SHEET NO.

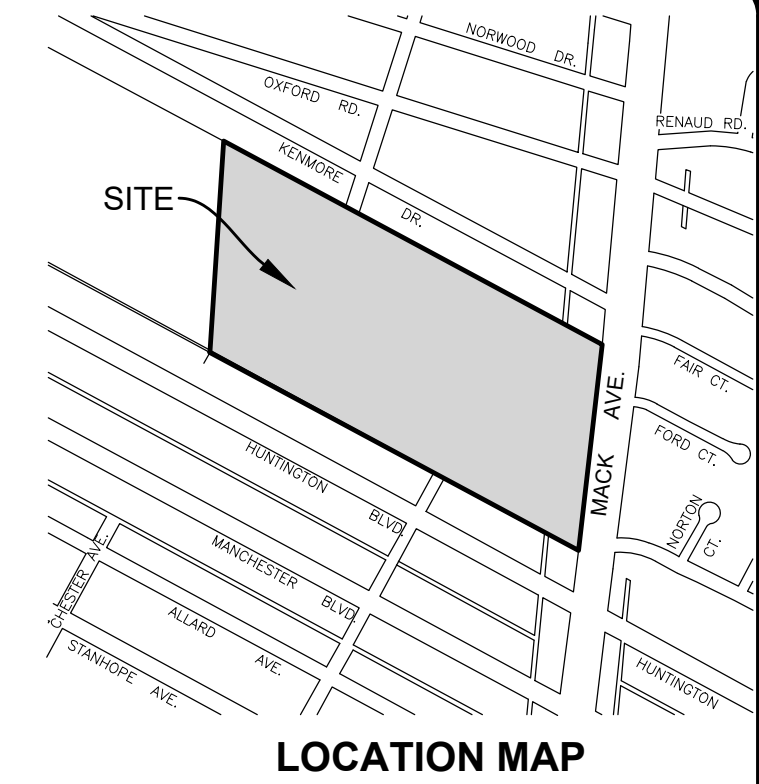
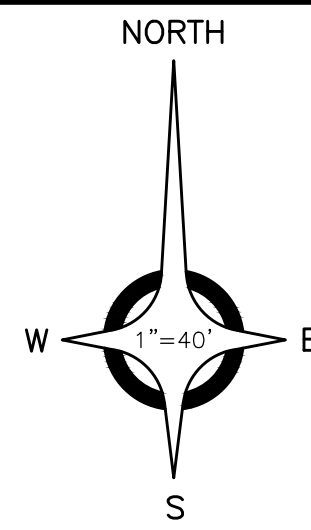

ANDERSON, ECKSTEIN AND WESTRICK, INC.
 CIVIL ENGINEERS SURVEYORS ARCHITECTS
 51301 Schoenherr Road Phone 586 726 1234
 Shelby Township Fax 586 726 8780
 Michigan 48315
 www.aewinc.com
 ENGINEERING STRONG COMMUNITIES

DATE	SUBMITTALS/REVISIONS

Ghesquiere Park Walking Path

SOIL EROSION & SEDIMENTATION CONTROL PLAN

CLIENT: CITY OF GROSSE POINTE WOODS

<input checked="" type="checkbox"/> PRELIMINARY	<input type="checkbox"/> CONSTRUCTION	<input type="checkbox"/> RECORD
DRAWN BY: JPB	CHECKED BY: RTW	DATE: NOVEMBER 2024
SCALE: 1" = 40' HORIZ.		
0 20 40 80		

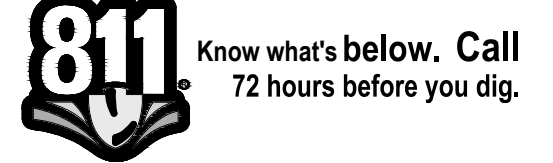

UTILITY INFORMATION, AS SHOWN, INDICATES APPROXIMATE LOCATIONS AND TYPES OF EXISTING FACILITIES ONLY, AS DISCLOSED BY RECORDS PROVIDED TO THIS FIRM FROM THE VARIOUS UTILITY COMPANIES. NO GUARANTEE IS GIVEN OR IMPLIED AS TO THE COMPLETENESS OR ACCURACY THEREOF.

PRIOR TO CONSTRUCTION, ALL LOCATIONS AND DEPTHS OF EXISTING OVERHEAD AND UNDERGROUND UTILITIES (IN CONFLICT WITH THE CONSTRUCTION OF THESE PROPOSED IMPROVEMENTS) SHALL BE VERIFIED IN THE FIELD. DURING THE CONSTRUCTION, THE CONTRACTOR SHALL PROTECT AND SUPPORT ALL UTILITIES THAT ARE ENCOUNTERED. (ALL COSTS FOR UTILITY LOCATION VERIFICATION, SUPPORT AND PROTECTION SHALL BE INCLUDED IN THE PROPOSED PAY ITEM CONFLICTING WITH THAT UTILITY).

DURING CONSTRUCTION, THE CONTRACTOR SHALL USE EXTREME CAUTION WHEN OPERATING NEAR ANY AND ALL OVERHEAD AND / OR BURIED UTILITIES.

PROJECT NO. 0160-0482

M:\0160\0482\CAD\DRAWINGS\CONSTRUCTION\CIVIL\01_CONSTR.PLAN.DWG
 09_SECT-11/26/2024 8:34:46 AM

SHEET NO.



ANDERSON, ECKSTEIN AND WESTRICK, INC.

CIVIL ENGINEERS SURVEYORS ARCHITECTS

51301 Schoenherr Road Phone 586 726 1234
Shelby Township Michigan 48315 Fax 586 726 8780

www.aewinc.com

ENGINEERING STRONG COMMUNITIES

SACK TYPE INLET FILTER (SESC-3)

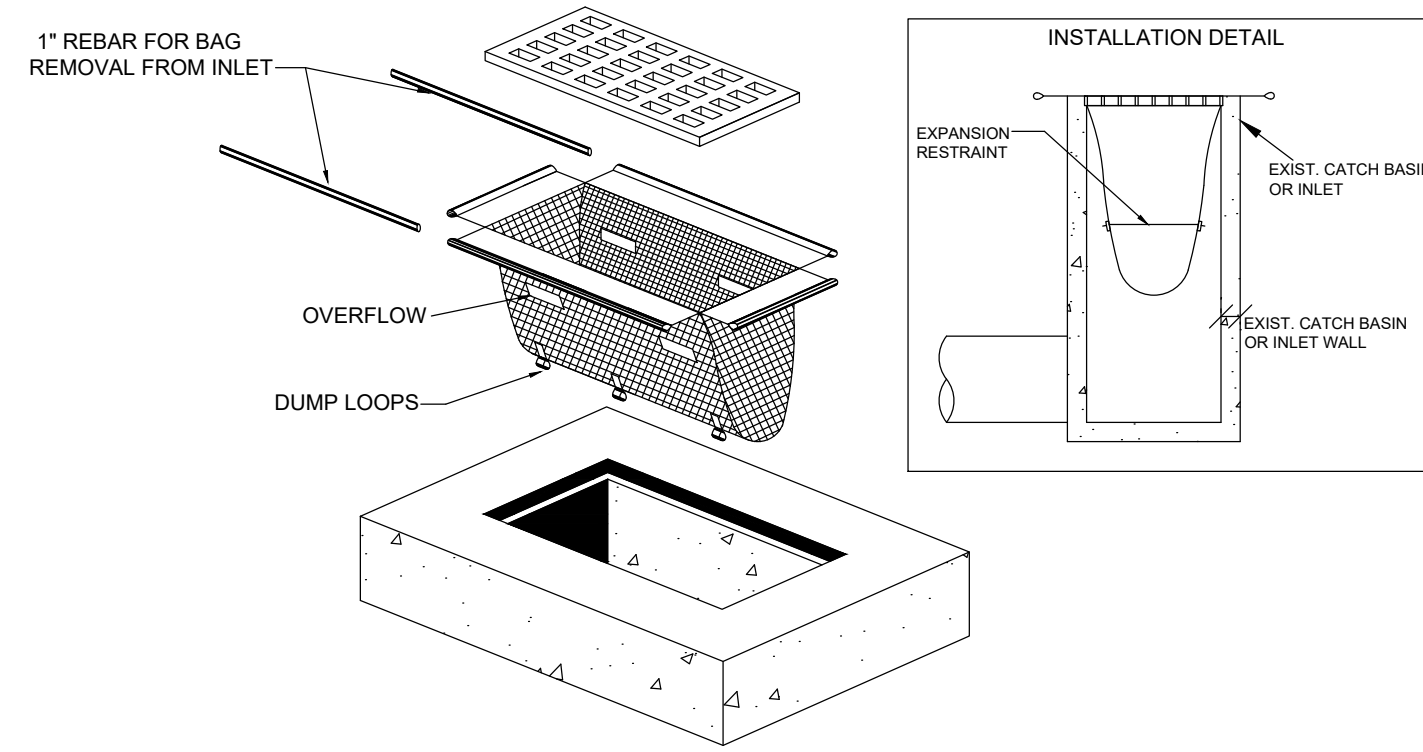

SedCatch® SedCage® - Yard Inlet Protection

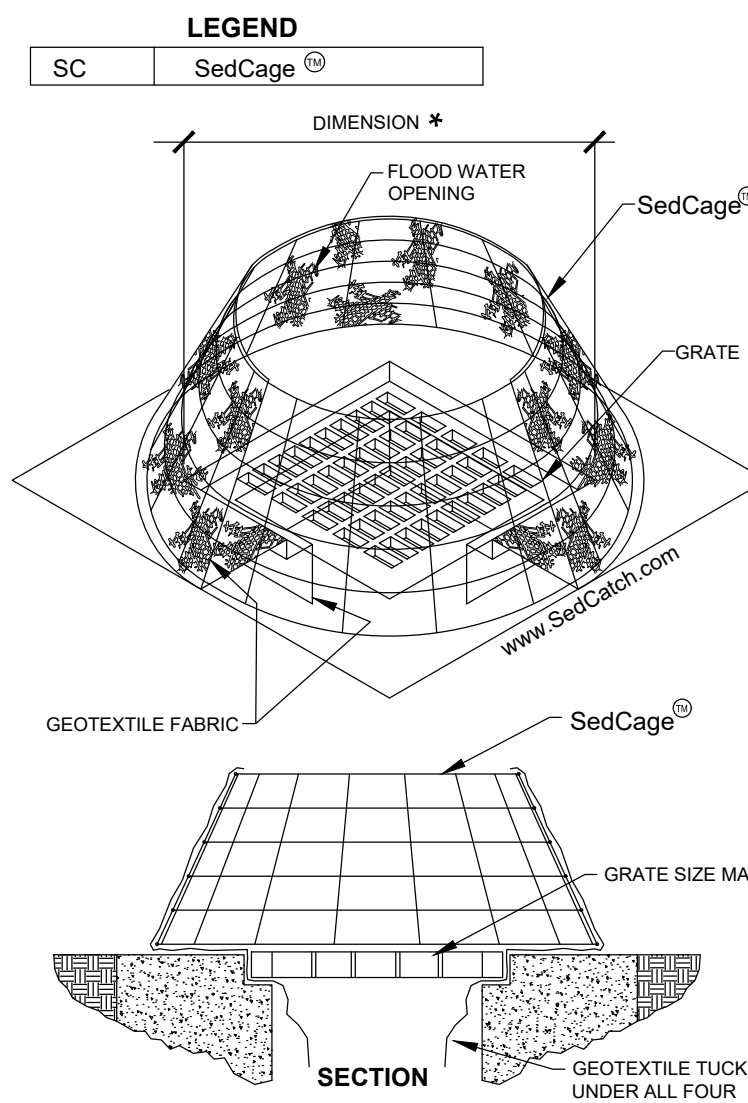

SIZING INSTRUCTIONS:
MEASURE THE DIAGONAL DIMENSION OF THE GRATE. SELECT A CAGE THAT IS AT LEAST 1\"/>

COMPATIBLE GRATES:
A SedCage® IS COMPATIBLE WITH ALL GRATES IN WHICH THE EDGES OF THE GRATE ARE SUPPORTED BY A LEDGE.

- SIZES:**
- 32" SedCage®
FITS SQUARE GRATES FROM 12" X 12" THROUGH 22" X 22"
FITS ROUND GRATES FROM 8" DIA. THROUGH 24" DIA.
FITS RECTANGULAR GRATES WITH A DIAGONAL BETWEEN 17" AND 31" ($a^2 + b^2 = c^2$)
 - 42" SedCage®
FITS SQUARE GRATES FROM 18" X 18" THROUGH 28" X 28"
FITS ROUND GRATES FROM 10" DIA. THROUGH 30" DIA.
FITS RECTANGULAR GRATES WITH A DIAGONAL BETWEEN 20" AND 41" ($a^2 + b^2 = c^2$)
 - 54" SedCage®
FITS SQUARE GRATES FROM 24" X 24" THROUGH 36" X 36"
FITS ROUND GRATES FROM 14" DIA. THROUGH 40" DIA.
FITS RECTANGULAR GRATES WITH A DIAGONAL BETWEEN 32" AND 53" ($a^2 + b^2 = c^2$)
 - 62" SedCage®
FITS SQUARE GRATES FROM 27" X 27" THROUGH 42" X 42"
FITS ROUND GRATES FROM 20" DIA. THROUGH 48" DIA.
FITS RECTANGULAR GRATES WITH A DIAGONAL BETWEEN 44" AND 51" ($a^2 + b^2 = c^2$)

FLOOD WATER CLEAR OPENING:

32" SedCage	230 sq. in.
42" SedCage	515 sq. in.
54" SedCage	1075 sq. in.
62" SedCage	1320 sq. in.

SedCatch® Environmental Products
www.SedCatch.com

US PATENT D 620,999, OTHER PATENTS PENDING

- INLET PROTECTION SHALL BE INSTALLED AT THE TIME THE STRUCTURE IS SET.
- TO INSTALL, TUCK FABRIC UNDER GRATE.
- REMOVE SEDIMENT IF IT ACCUMULATES TO ONE HALF THE HEIGHT OF THE SedCage®.
- THE AREA AROUND THE SedCage® SHOULD BE AS FLAT AS POSSIBLE TO INCREASE EFFECTIVENESS AND REDUCE MAINTENANCE REQUIREMENTS.
- AS WITH ALL INLET PROTECTION DEVICES, CHECK TO SEE HOW DEEP THE WATER COULD RISE IF THE INLET WERE BLOCKED ENTIRELY. DO NOT INSTALL IN LOCATIONS THAT COULD CAUSE PROPERTY DAMAGE OR POSE A SAFETY HAZARD TO TRAFFIC.

SOIL EROSION AND SEDIMENTATION NOTES AND MAINTENANCE NOTES

THIS PROJECT SHALL BE CONSTRUCTED IN COMPLIANCE WITH PART 91 OF ACT 451 OF 1994, AS AMENDED, THE SOIL EROSION AND SEDIMENTATION CONTROL ACT AND THE WAYNE COUNTY SOIL EROSION AND SEDIMENTATION CONTROL ORDINANCE.

ALL EROSION AND SEDIMENTATION CONTROL WORK SHALL CONFORM TO THE STANDARDS AND SPECIFICATIONS OF THE WAYNE COUNTY PUBLIC WORKS OFFICE.

EROSION AND ANY SEDIMENTATION FROM WORK ON THIS SITE SHALL BE CONTAINED ON THE SITE AND NOT ALLOWED TO COLLECT ON ANY OFF SITE AREAS OR IN WATERWAYS. WATERWAYS INCLUDE BOTH NATURAL AND MAN MADE OPEN DITCHES, STREAMS, STORM DRAINS, LAKES AND PONDS.

STAGING THE WORK WILL BE DONE BY THE CONTRACTOR AS DIRECTED IN THESE PLANS AND AS REQUIRED TO ENSURE PROGRESSIVE STABILIZATION OF DISTURBED EARTH CHANGE.

THE CONTRACTOR SHALL BE RESPONSIBLE FOR INSTALLATION AND MAINTENANCE OF SOIL EROSION AND SEDIMENTATION CONTROL DEVICES.

THE CONTRACTOR SHALL IMPLEMENT AND MAINTAIN THE SOIL EROSION CONTROL MEASURES AS SHOWN ON THE PLANS BEFORE AND AT ALL TIMES DURING CONSTRUCTION ON THIS PROJECT. ANY MODIFICATIONS OR ADDITIONS TO SOIL EROSION CONTROL MEASURES DUE TO CONSTRUCTION OR CHANGED CONDITIONS SHALL BE COMPLIED WITH AS REQUIRED OR DIRECTED BY THE WAYNE COUNTY PUBLIC WORKS OFFICE.

IF ANY OF THE SESC MEASURES ON THE SITE ARE DEEMED INADEQUATE OR INEFFECTIVE, THE WAYNE COUNTY PUBLIC WORKS OFFICE SESC DIVISION HAS THE RIGHT TO REQUIRE ADDITIONAL SESC MEASURES.

INSTALL INLET FILTER ON ALL PAVEMENT CATCH BASINS PER DETAIL.

- A. INLET FILTERS SHALL BE INSPECTED WEEKLY UNDER NORMAL CONDITIONS, WITHIN 24 HOURS OF A RAINFALL AND DAILY DURING A PROLONGED RAIN EVENT.
- B. BUILDUP OF SEDIMENT AND DEBRIS SHALL BE REMOVED PROMPTLY.
- C. IF FABRIC DECOMPOSES OR BECOMES INEFFECTIVE PRIOR TO THE END OF EXPECTED USABLE LIFE AND THE BARRIER IS STILL REQUIRED, THE FABRIC SHALL BE REPLACED PROMPTLY.

NO STOCKPILED SOIL IS PLANNED FOR THIS PROJECT.

ALL DISTURBED AREAS WILL BE RESTORED WITH 3" MIN. TOPSOIL, SEED, FERTILIZER & MULCH INCLUDED IN PAY ITEM 'Site Restoration and Cleanup'.

NO DEWATERING IS PLANNED DURING CONSTRUCTION.

ALL DIRT TRACKED ONTO ANY ROADWAY SHALL BE REMOVED IMMEDIATELY.

STREETS AND OR PARKING AREAS WILL BE SCRAPPED ON A DAILY BASIS AND SWEEPED AT A MINIMUM OF ONCE PER WEEK BY THE CONTRACTOR.

DURING DRY PERIODS, ALL DISTURBED AREAS SHALL BE WATERED FOR DUST CONTROL.

PERMANENT SOIL EROSION CONTROL MEASURES FOR ALL SLOPES, CHANNELS, DITCHES, OR ANY DISTURBED LAND AREA SHALL BE COMPLETED WITHIN 5 CALENDAR DAYS AFTER FINAL GRADING OR THE FINAL EARTH CHANGE HAS BEEN COMPLETED. WHEN IT IS NOT POSSIBLE TO PERMANENTLY STABILIZE A DISTURBED AREA AFTER EARTH CHANGE ACTIVITY CEASES, TEMPORARILY SOIL EROSION CONTROL MEASURES SHALL BE IMPLEMENTED IMMEDIATELY. ALL TEMPORARY SOIL EROSION CONTROL SHALL BE MAINTAINED UNTIL PERMANENT SOIL EROSION CONTROL MEASURES ARE IMPLEMENTED. ALL PERMANENT SOIL EROSION CONTROL MEASURES WILL BE IMPLEMENTED AND ESTABLISHED BEFORE A CERTIFICATE OF COMPLIANCE IS ISSUED.

FINAL GRADE, ESTABLISH VEGETATION AND OR LANDSCAPE ALL DISTURBED AREAS NOT BUILT OR PAVED UPON.

REMOVE ALL TEMPORARY SOIL EROSION DEVICES AFTER PERMANENT STABILIZATION IS ESTABLISHED.

SOIL TYPES: M1daaA, UrbarB, WsnuaA, ZfsucB

NAME OF NEAREST WATERCOURSE: Milk River
DISTANCE TO NEAREST WATERCOURSE IN FEET: 5,800 Feet

PERSON RESPONSIBLE FOR THE MAINTENANCE OF ALL TEMPORARY SOIL EROSION CONTROL MEASURES WILL BE PROVIDED WHEN THE CONTRACTOR IS DETERMINED.

DATE	SUBMITTALS/REVISIONS

PROJECT NAME:

Ghesquiere Park Walking Path

SHEET TITLE:

SOIL EROSION & SEDIMENTATION CONTROL PLAN

CLIENT:
CITY OF GROSSE POINTE WOODS

<input checked="" type="checkbox"/> PRELIMINARY	<input type="checkbox"/> CONSTRUCTION	<input type="checkbox"/> RECORD
DRAWN BY: JPB	CHECKED BY: RTW	DATE: NOVEMBER 2024
SCALE:		

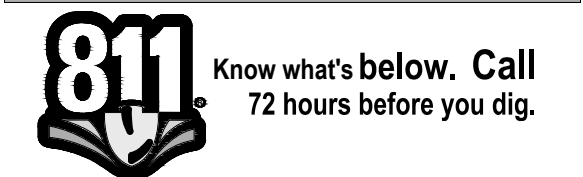

UTILITY INFORMATION, AS SHOWN, INDICATES APPROXIMATE LOCATIONS AND TYPES OF EXISTING FACILITIES ONLY, AS DISCLOSED BY RECORDS PROVIDED TO THIS FIRM FROM THE VARIOUS UTILITY COMPANIES. NO GUARANTEE IS GIVEN OR IMPLIED AS TO THE COMPLETENESS OR ACCURACY THEREOF.

PRIOR TO CONSTRUCTION, ALL LOCATIONS AND DEPTHS OF EXISTING OVERHEAD AND UNDERGROUND UTILITIES (IN CONFLICT WITH THE CONSTRUCTION OF THESE PROPOSED IMPROVEMENTS) SHALL BE VERIFIED IN THE FIELD. DURING THE CONSTRUCTION, THE CONTRACTOR SHALL PROTECT AND SUPPORT ALL UTILITIES THAT ARE ENCOUNTERED. (ALL COSTS FOR UTILITY LOCATION VERIFICATION, SUPPORT AND PROTECTION SHALL BE INCLUDED IN THE PROPOSED PAY ITEM CONFLICTING WITH THAT UTILITY).

DURING CONSTRUCTION, THE CONTRACTOR SHALL USE EXTREME CAUTION WHEN OPERATING NEAR ANY AND ALL OVERHEAD AND / OR BURIED UTILITIES.

PROJECT NO. 0160-0482

M:\0160\0482\CAD\DRAWINGS\CONSTRUCTION\CIVIL\01_CONSTRPLANS.DWG
10_SESC-11/26/2024 8:34:47 AM

SHEET NO.

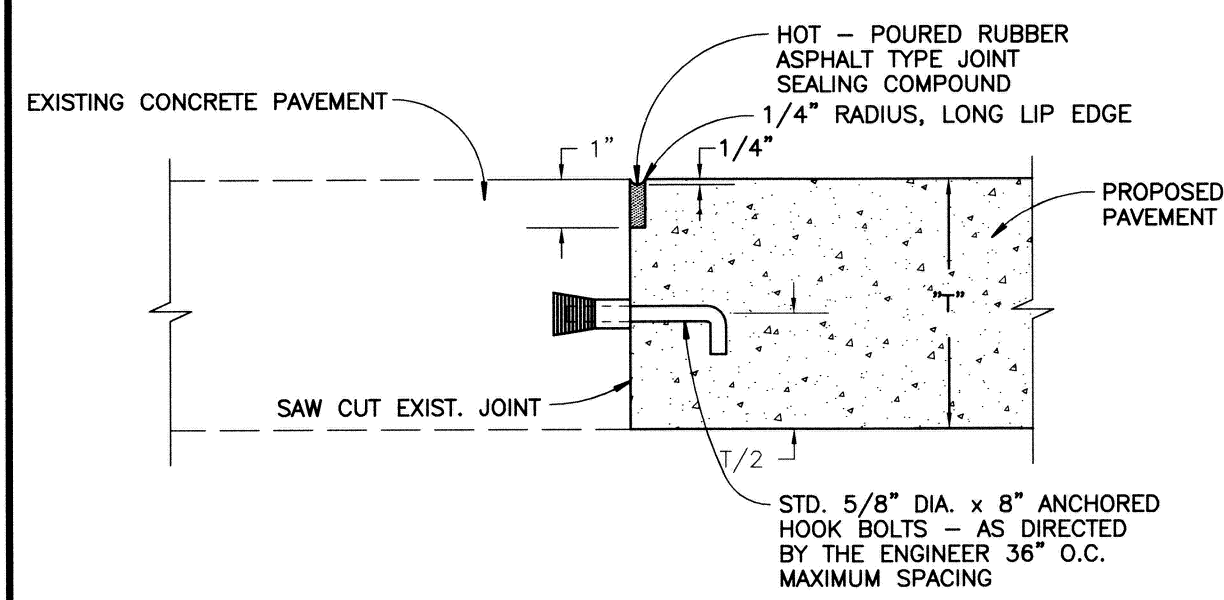

A CONSTRUCTION JOINTS

USE JOINT (A) OR (B) IF REPLACEMENT CONCRETE EXTENDS BEYOND EXPANSION ANCHOR HOOK BOLTS.

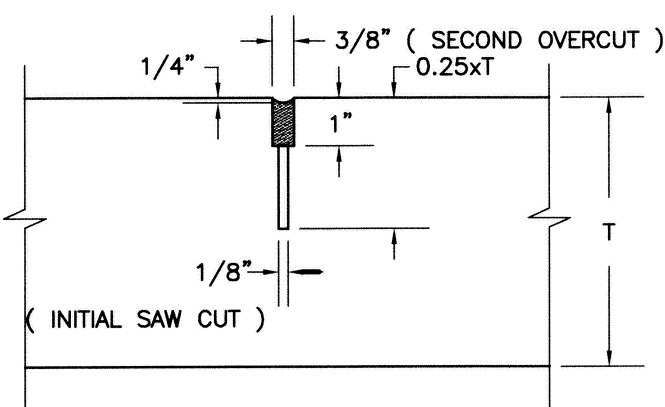

B TRANSVERSE / LONGITUDINAL PLANE OF WEAKNESS JOINT

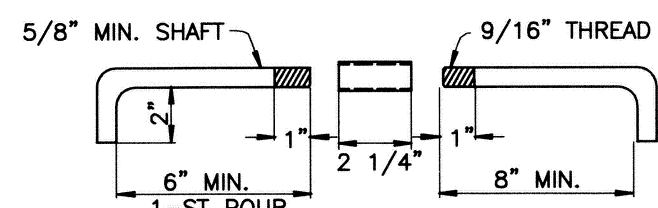

C HOOK BOLT DETAIL

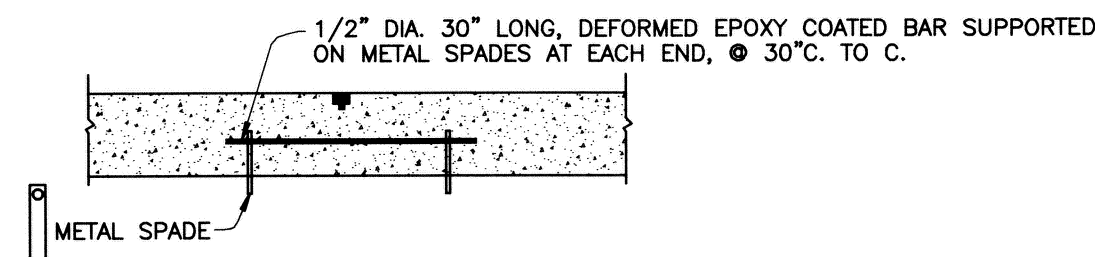

D TIEBAR DETAIL

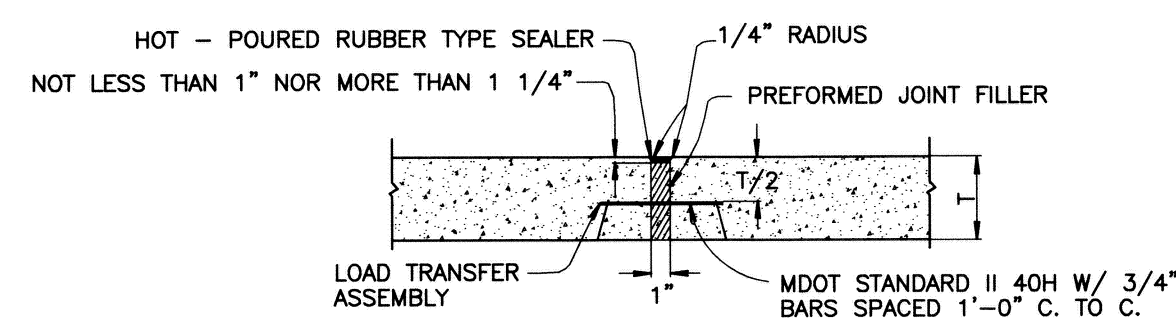

1 LOAD TRANSFER ASSEMBLY WITH PREFORMED EXPANSION JOINT FILLER

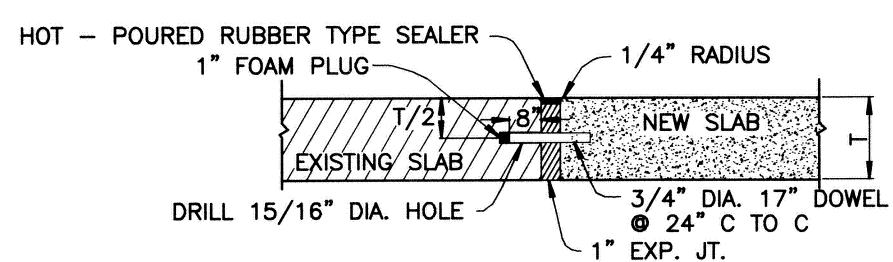

2 EXPANSION JOINT WITH 3/4 inch DOWELS

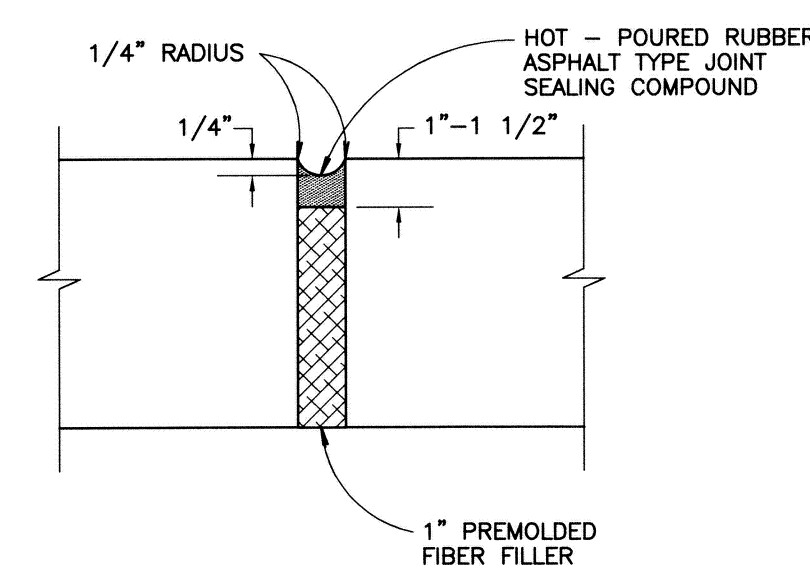

3 EXPANSION JOINT

4 EXPANSION JOINT SPACING

DAYTIME TEMPERATURES 50°F AND ABOVE:
AT ALL INTERSECTIONS; MAXIMUM SPACING 700 FEET; AS SHOWN ON PLANS.
DAYTIME TEMPERATURES BELOW 50°F:
AT ALL INTERSECTIONS; MAXIMUM SPACING 450 FEET; AS SHOWN ON PLANS.

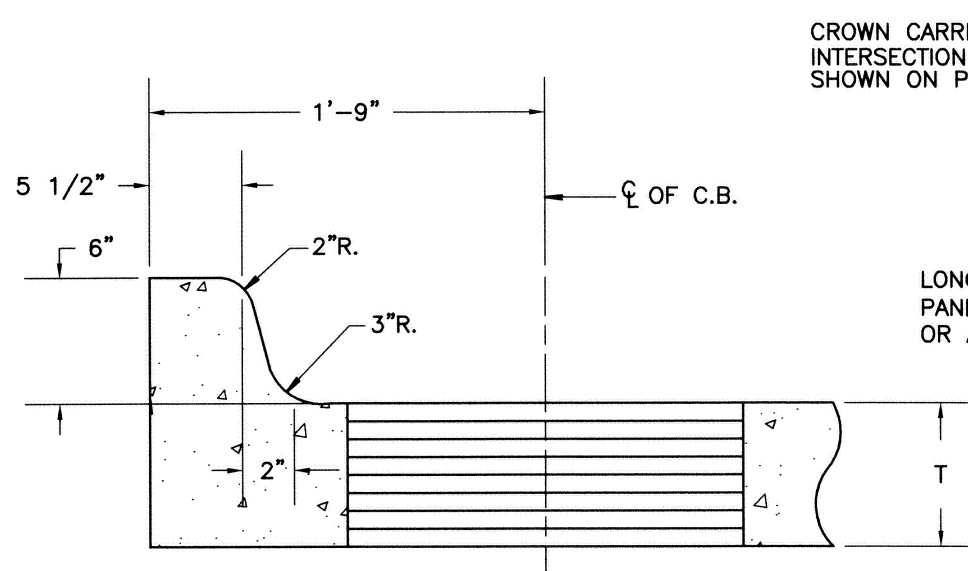

6 inch CURB DETAIL INTEGRAL WITH CONCRETE PAVEMENT (TYPICAL)

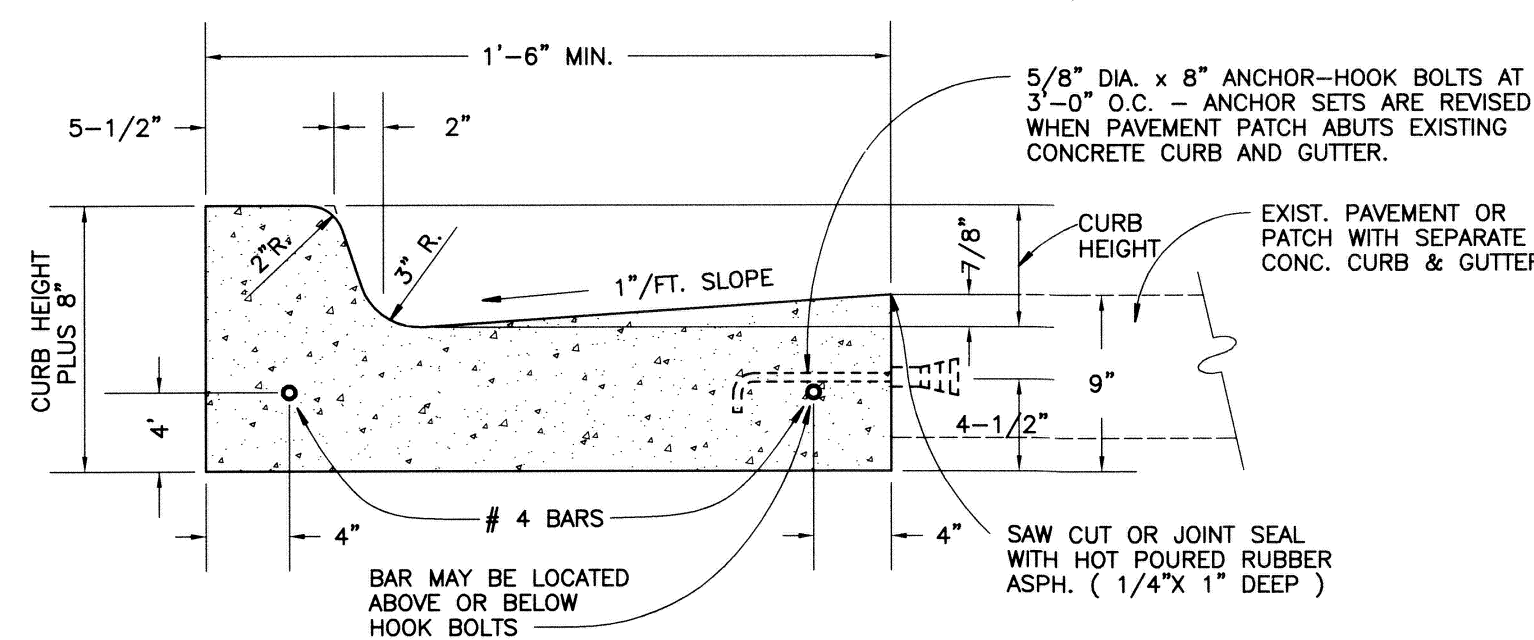

TYPICAL CONCRETE CURB AND GUTTER DETAIL

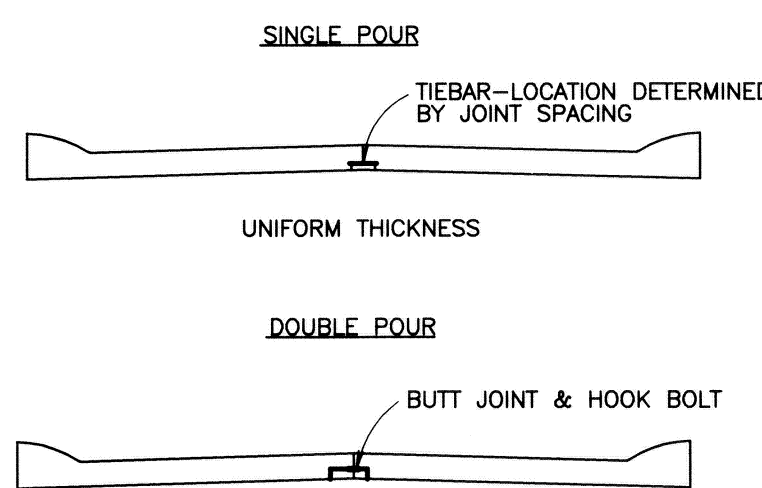

PAVEMENT SECTION

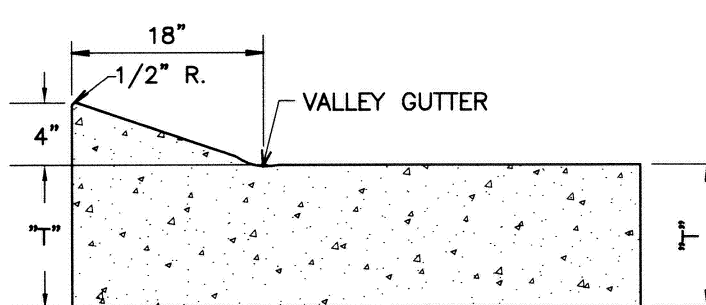

4 inch MOUNTABLE CONCRETE INTEGRAL CURB (NON-REINFORCED)

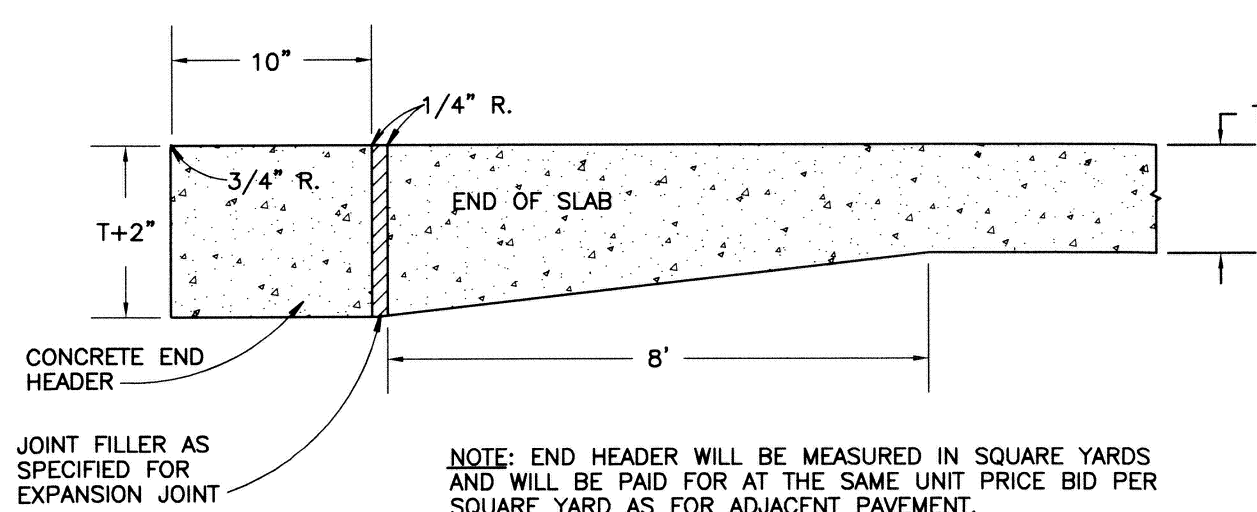

END HEADER

5 JOINTING DETAIL

- 1. BUTT JOINT OR
- 2. PREFORMED STRIP
- 3. SAWED WEAKENED PLANE JOINT

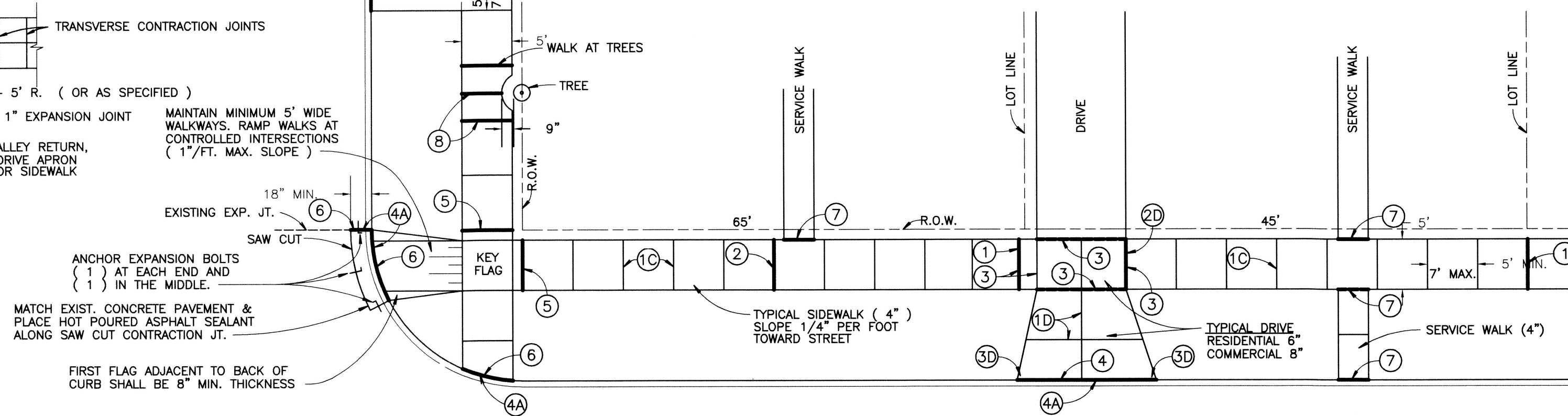

*** EXPANSION JOINTS**

- 1 PLACE 1/2" FIBER EXP. JOINT FILLERS AT LOT LINES WHEN LOTS ARE 50' OR LESS.
- 2 ADDITIONAL 1/2" FIBER EXP. JOINT FILLERS FOR LOTS GREATER THAN 50', NOT TO EXCEED 50' INTERVALS.
- 3 PLACE 1/2" FIBER EXP. JOINT FILLERS EACH SIDE, IF EDGE OF DRIVE IS WITHIN 2' OF LOT LINES PLACE EXPANSION PAPER AT PROPERTY LINE.
- 4 PLACE 1" FIBER EXP. JOINT FILLERS AT CURB AND BUILDING OR R.O.W. LINE.
- 4A AT CURB LINE, EXPANSION JOINTS SHALL BE SEALED WITH HOT RUBBERIZED SEALANT.
- 5 PLACE 1/2" FIBER EXP. JOINT FILLERS AT R.O.W. LINES OF CROSS - WALKS.
- 6 PLACE 1" FIBER EXP. JOINT FILLERS AT INTERSECTIONS OF CURB RADIUS AND IN LINE WITH EXISTING JOINTS.
- 7 PLACE 1/2" FIBER EXP. JOINT FILLER AT INTERSECTION OF SERVICE WALK & CURB ALSO AT SERVICE WALK & WALK.

CONTRACTION JOINTS

- 8 PLACE 1/2" FIBER EXP. JOINT FILLERS AT EITHER SIDE OF SIDEWALK ABUTTING TREE AND AT CENTERLINE JOINT.
- 10 PLACE CONTRACTION JOINTS AT INTERVALS NOT LESS THAN 5' OR GREATER THAN 7'. FULL WIDTH OF WALK. JOINT DEPTH SHALL BE 1/2 THICKNESS OF CONCRETE.
- 20 PLACE CONTRACTION JOINTS AT WALK LINES FOR FULL WIDTH SIDEWALK.

DRIVEWAYS

- 10 PLACE CONTRACTION JOINTS SO THAT NO SECTION OF THE CONCRETE DRIVEWAY EXCEEDS A DIMENSION OF 15'x15'.
- 20 PLACE 1" FIBER EXPANSION FILLER AT ALL SIDES OF A COMMERCIAL DRIVE.
- 30 WIDTH OF APPROACH AT STREET SHOULD BE MIN. 2' WIDER THAN WIDTH AT SIDEWALK, EACH SIDE.

* FIBER EXPANSION JOINT FILLERS SHALL BE FULL DEPTH

NOTES

- 1. CONCRETE WORK NOT CONSTRUCTED UNDER THE CITY'S CONTRACTOR, MUST BE DONE UNDER A PERMIT, SECURED THROUGH THE CITY'S ENGINEERING DEPARTMENT.
- 2. NO CONCRETE SHALL BE PLACED UNTIL A PRE-CHECK HAS BEEN REQUESTED BY THE CONTRACTOR OR HOME-OWNER AND APPROVED BY THE CITY'S ENGINEERING DEPARTMENT AT LEAST (8) HOURS IN ADVANCE, FINAL INSPECTION IS ALSO REQUIRED AT PLACEMENT OF CONCRETE.
- 3. ALL WORK SHALL CONFORM TO THE CITY'S STANDARDS & SPECIFICATIONS AVAILABLE THROUGH THE ENGINEERING DEPARTMENT.
- 4. HANDICAP RAMP SHALL MEET PAVEMENT GUTTER ELEVATION. NO LIP PERMITTED.

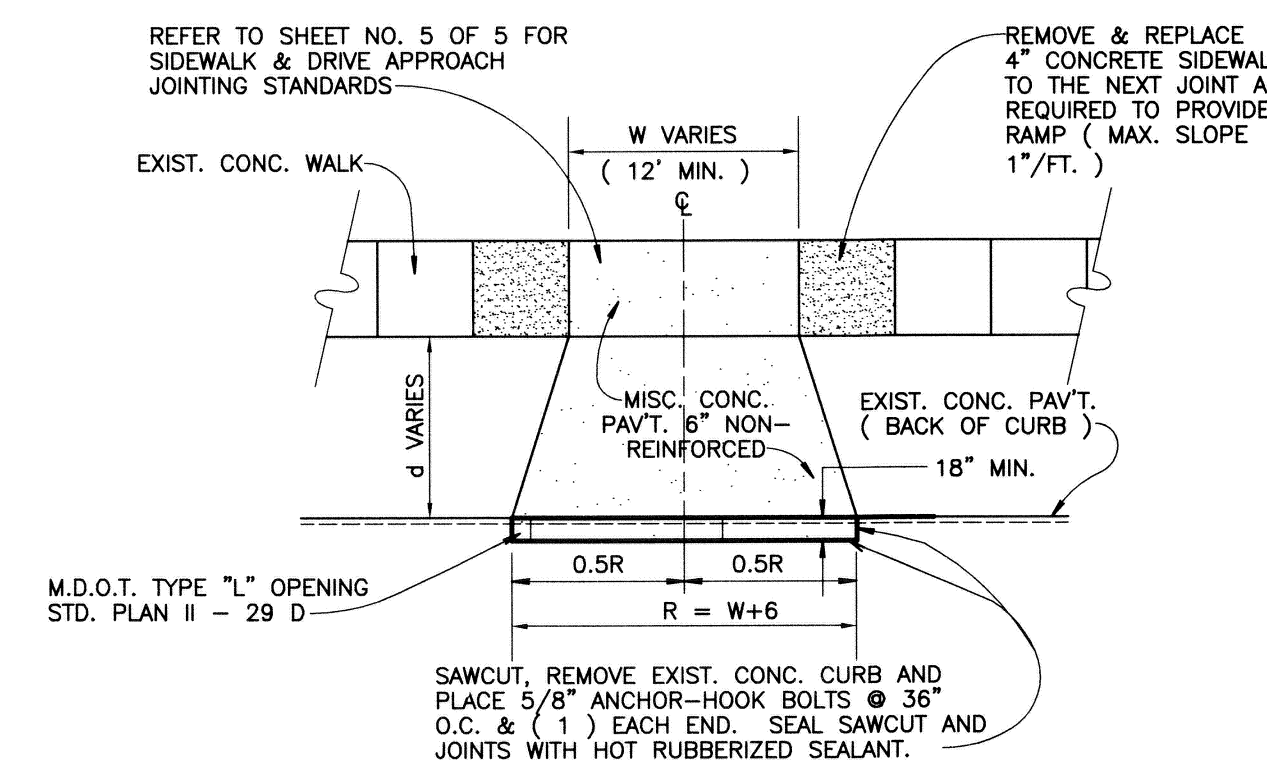

NEW RESIDENTIAL DRIVEWAY LAYOUT FOR EXISTING PAVEMENT CONDITION

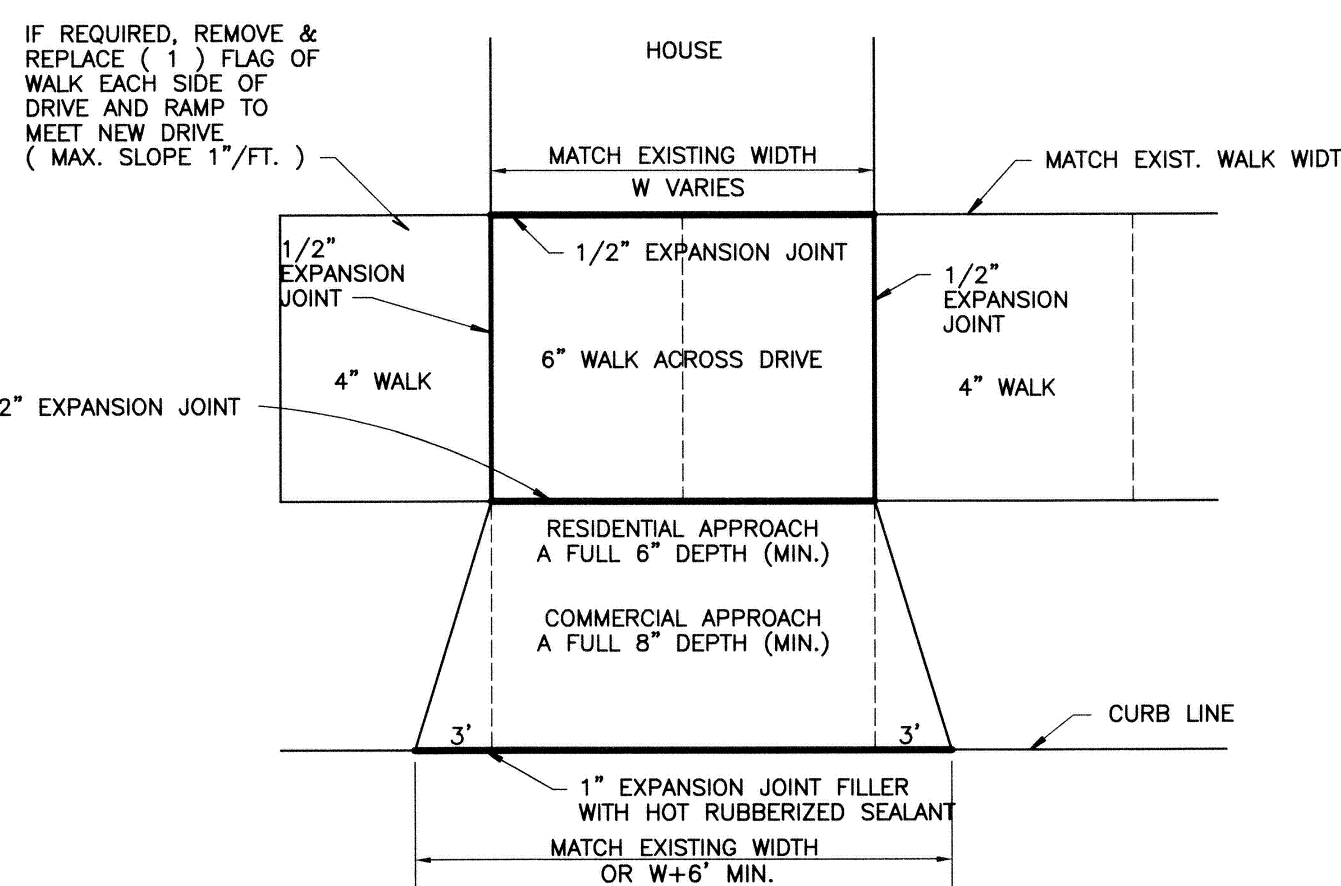

REMOVAL AND REPLACEMENT OF EXISTING DRIVE APPROACH FOR EXISTING OR NEW PAVEMENT CONDITION

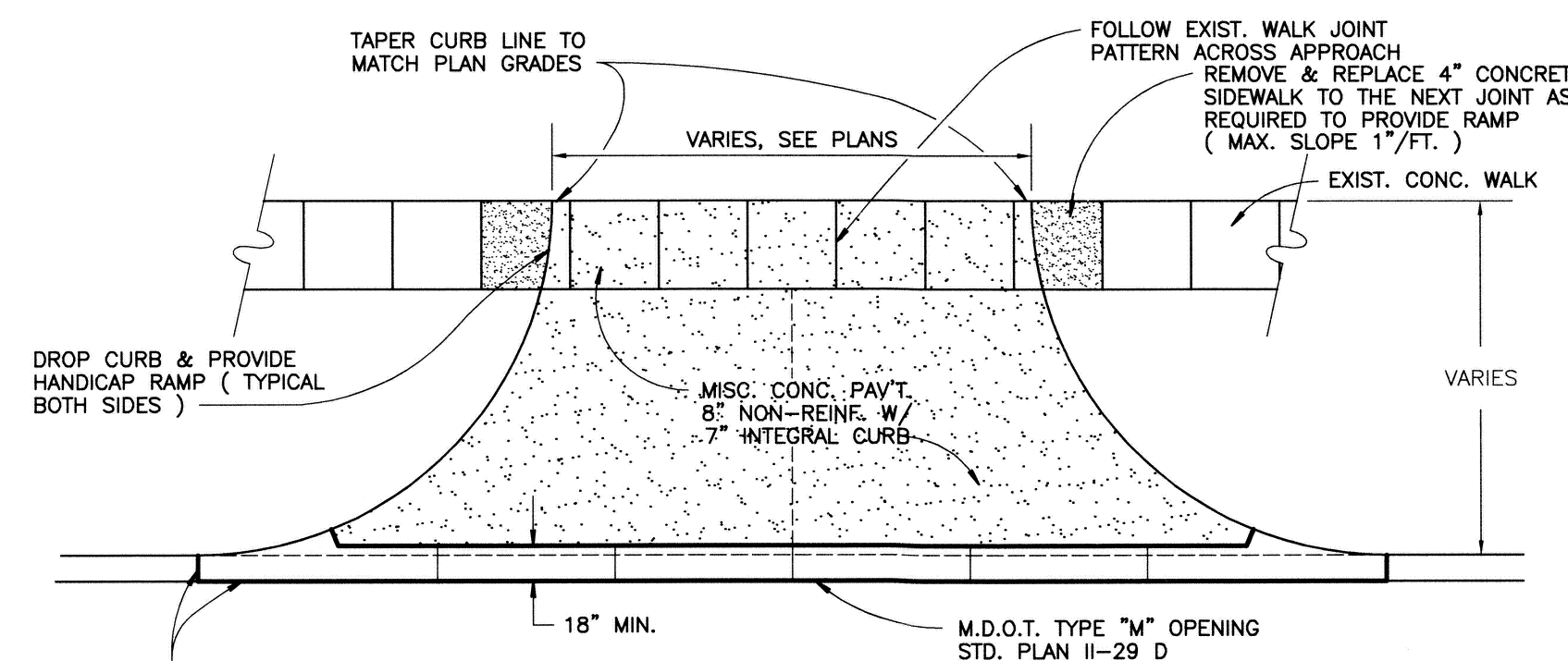

NEW COMMERCIAL DRIVEWAY LAYOUT FOR EXISTING PAVEMENT CONDITION

CITY OF GROSSE POINTE WOODS STANDARD PAVING DETAILS

DEPARTMENT OF PUBLIC WORKS

APPROVED BY: *Joseph J. Miller Jr.* JOSEPH J. MILLER JR., DPW DIRECTOR

DATE: 2/6/07

ANDERSON, ECKSTEIN AND WESTRICK, INC.
Civil Engineers • Surveyors • Architects
51301 Schoenherr Road, Shelby Township, Michigan 48315
Phone 586-726-1234 Fax 586-726-8780

PROJECT NO. SHEET NO.
DATE: FEBRUARY, 2007
DRAWN BY: DMS CHECKED BY: FDV

E

STATE OF MICHIGAN
SCOTT LOCKWOOD
ENGINEER
No. 44355
LICENSED PROFESSIONAL ENGINEER

SCOTT LOCKWOOD P.E. NO. 44355